

# COUNTY OF DORSET PARISH OF KAY PORTION OF THE BRANXHOLM ESTATE

Scale 4 chains to an Inch

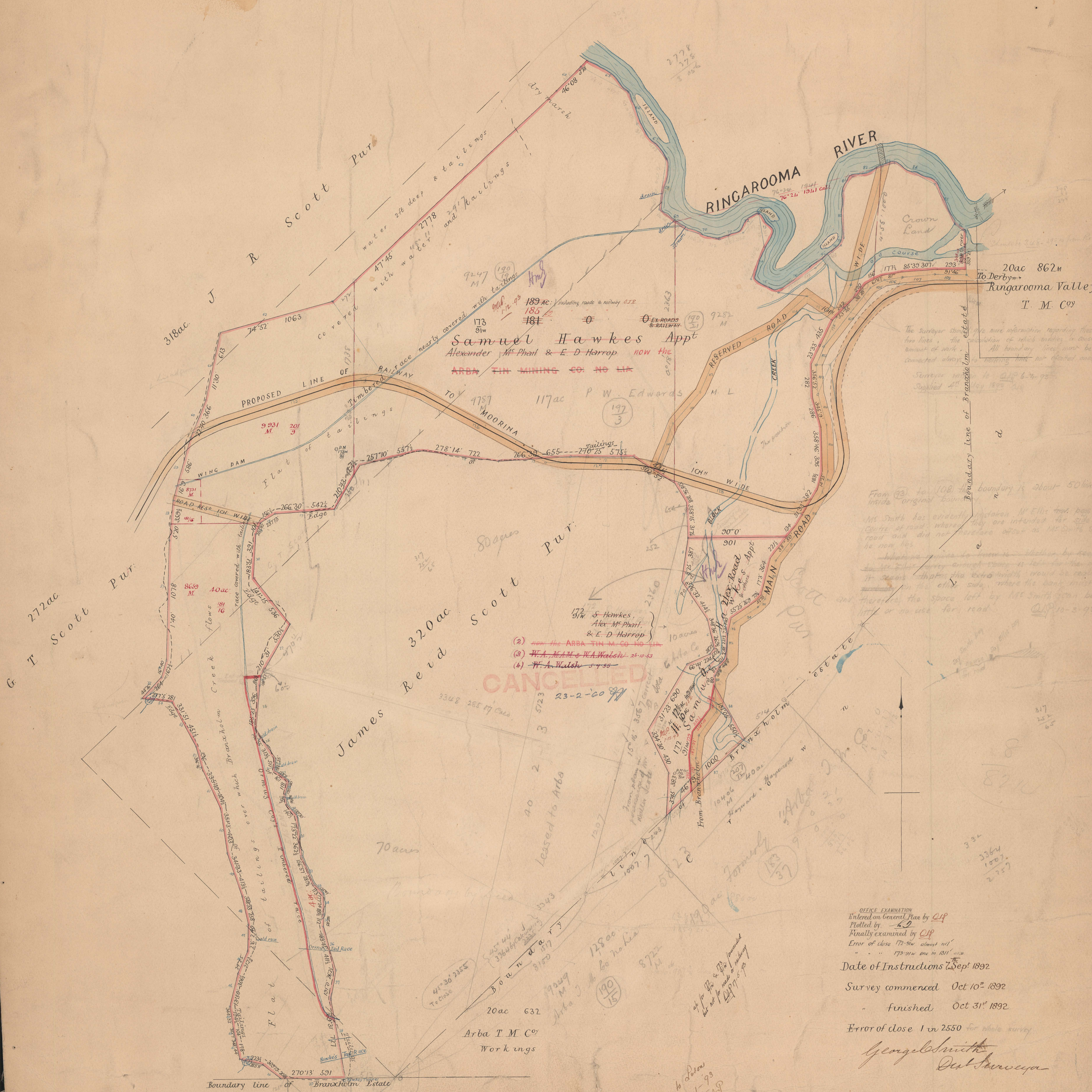
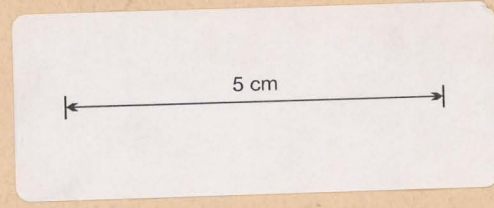

20ac 862M  
To Derby  
Ringarooma Valley  
T. M. Coy

- (1) ARBA T.M. CO. NO. 114
- (2) H.A. WALSH 5-1-93
- (3) H.A. WALSH & W.A. WALSH 21-10-93
- (4) H.A. WALSH 5-1-93

CANCELLED

OFFICE EXAMINATION  
Entered on General Plan by *OP*  
Plotted by *OP*  
Finally examined by *OP*  
Error of close 1 in 2550 for whole survey  
Date of Instructions 7<sup>th</sup> Sep 1892  
Survey commenced Oct 10<sup>th</sup> 1892  
finished Oct 31<sup>st</sup> 1892  
Error of close 1 in 2550 for whole survey  
*George Smith*  
Dist. Surveyor

16

172  
91W  
Cancelled 23-2-60  
27

# BRANXHOLM TAILINGS AREA

BY G.C. SMITH SENR

16

2/11/61  
G.C. SMITH