

N^o OF APPLICATION

COUNTY OF KENT
VICY OF BATHURST RANGE
PARISH OF

Scale 80 chains to an inch

REFERENCE TO CORNERS

COR.	BEARING	DISTANCE IN CHAINS	FROM

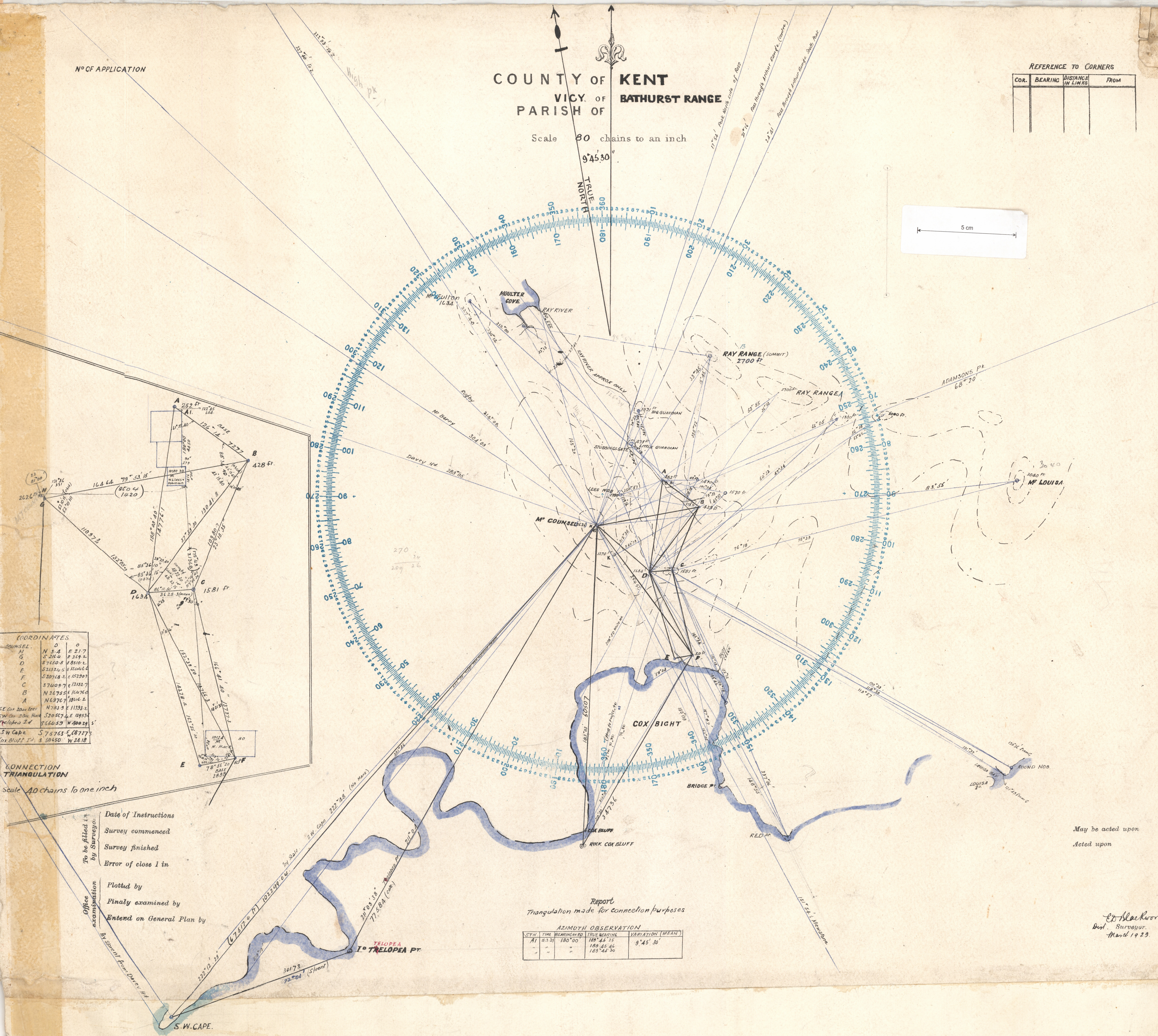
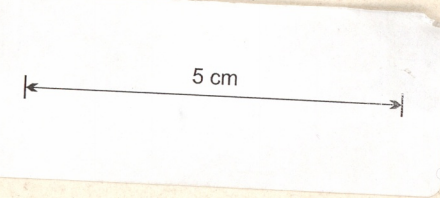

COORDINATES

POINT	N	E
Q <td>0</td> <td>0</td>	0	0
H	5.4	21.7
G	26.4	24.4
D	75.0	85.0
E	212.4	126.6
F	207.8	152.9
C	37.0	125.7
B	26.7	16.7
A	6.7	10.2

CONNECTION TRIANGULATION
Scale 40 chains to one inch

To be filed by Surveyor

Date of Instructions

Survey commenced

Survey finished

Error of close 1 in

Plotted by

Finally examined by

Entered on General Plan by

Office examination

By Special Exam. Duties, etc.

Report
Triangulation made for connection purposes

STN	TIME	BEARING	TO	BEARING	VARIATION (MEAN)
A1	8.3.25	180° 00'	189° 44' 25"	9° 44' 30"	
"	"	"	189° 45' 46"	"	
"	"	"	189° 44' 30"	"	

May be acted upon
Acted upon

E. Blackwood
Dist. Surveyor
March 1923