

740 D.C. 38 ac.
L.J. & R.E. Smith
M.L.

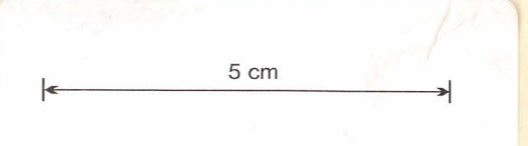

COUNTY OF RUSSELL & TOWN OF WARATAH

VICINITY OF M^r BISCHOFF

Scale: 6 chains to an inch

REFERENCE TO CORNERS

CORNER	BEARING	DISTANCE	FROM
48	158° 28'	13.3	Myrtle
67	24° 47'	43	"
73	154° 51'	31.4	O.R.M.
80		5.8	Leatherwood
81	735° 07'	18.4	Myrtle
94	87° 50'	52.3	"
105	138° 54'	34.8	O.R.M. Myrtle
123	303° 51'	12	Stamp
137	108° 27'	19.6	O.M.
147	114° 08'	38	O.R.M. Sky Bark
149	15° 21'	22	Stamp
153	287° 30'	86	Clary Pine
160	173° 13'	13.1	O.M. Myrtle

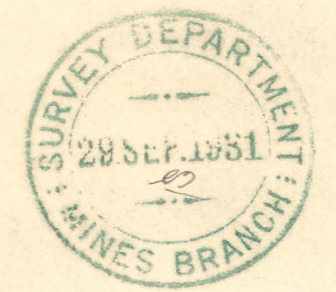

C
T
O
W
N
O
F
R
U
S
S
E
L
L

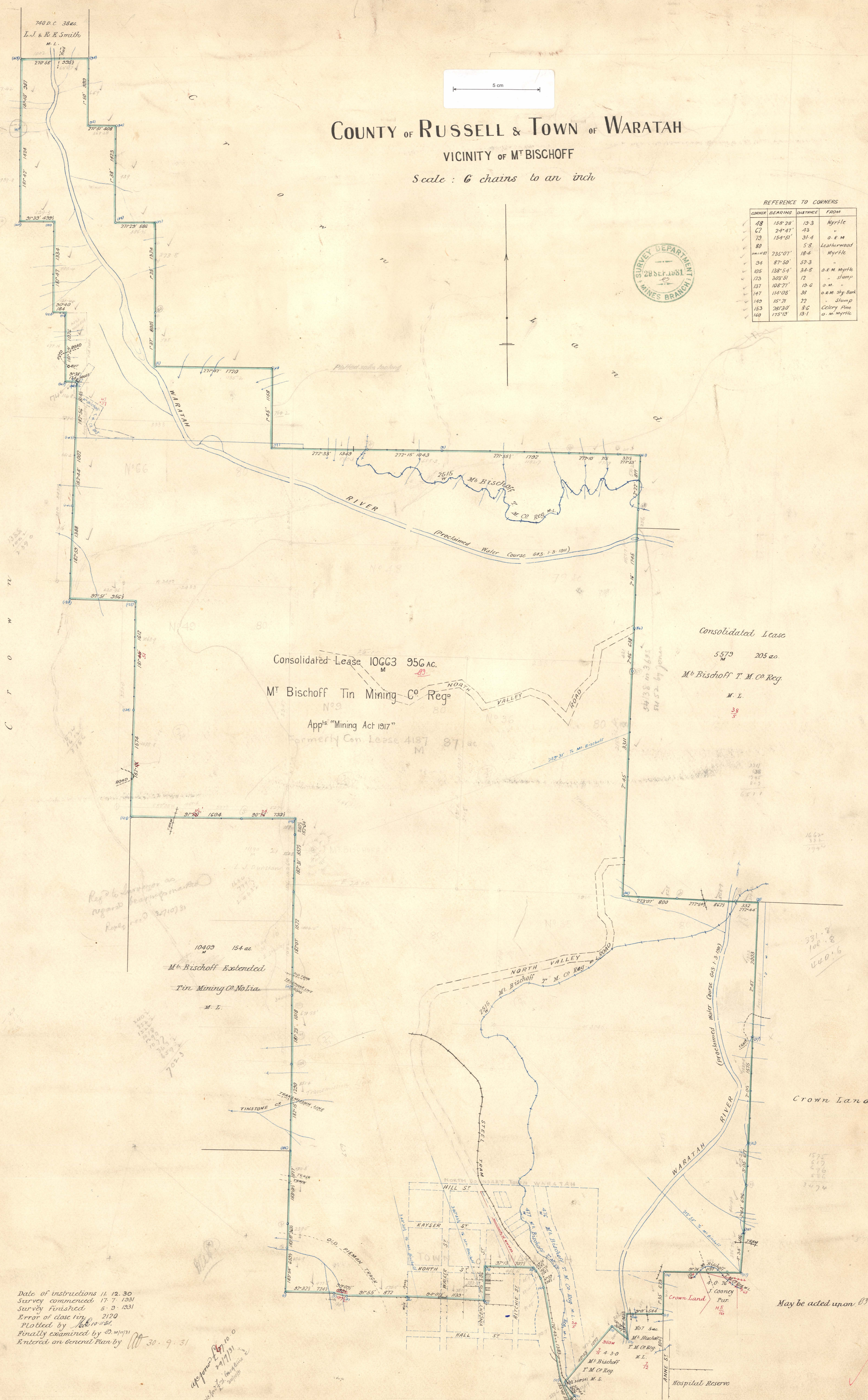

Consolidated Lease 10663 956 ac.

M^r Bischoff Tin Mining Co Reg^d

App^ls "Mining Act 1917"

Formerly Con. Lease 4187 87 ac.

Consolidated Lease

5579 205 ac.

M^r Bischoff T.M. Co Reg^d

M.L.

38

5

M^r Bischoff Extended

Tin Mining Co. No. 11a

M.L.

Crown Land

Date of instructions 11.12.30
Survey commenced 17.7.1931
Survey finished 5.5.1931
Error of close ring 2120
Plotted by [signature]
Finally examined by [signature]
Entered on General Plan by [signature] 30.9.31

400 [unclear] 100
20/1/31

May be acted upon. 23/11/31

Arthur [signature]
District Surveyor

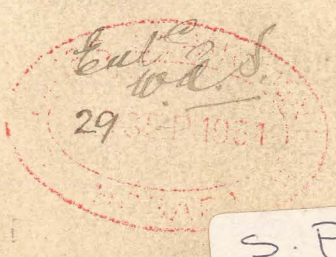

M^{rs} BISCHOFF T.M. Co REG.
Resurvey by A.C. Hall 1931.
CONSOLIDATED LEASE 10663
M
105

105

M^{rs} BISCHOFF T.M. Co REG.
RE-SURVEY BY A.C. HALL 1931.
CONSOLIDATED LEASE 10663
M

105