

S.P.
121-01



COUNTY OF RUSSELL

SAVAGE RIVER

SCALE FIVE CHAINS TO AN INCH

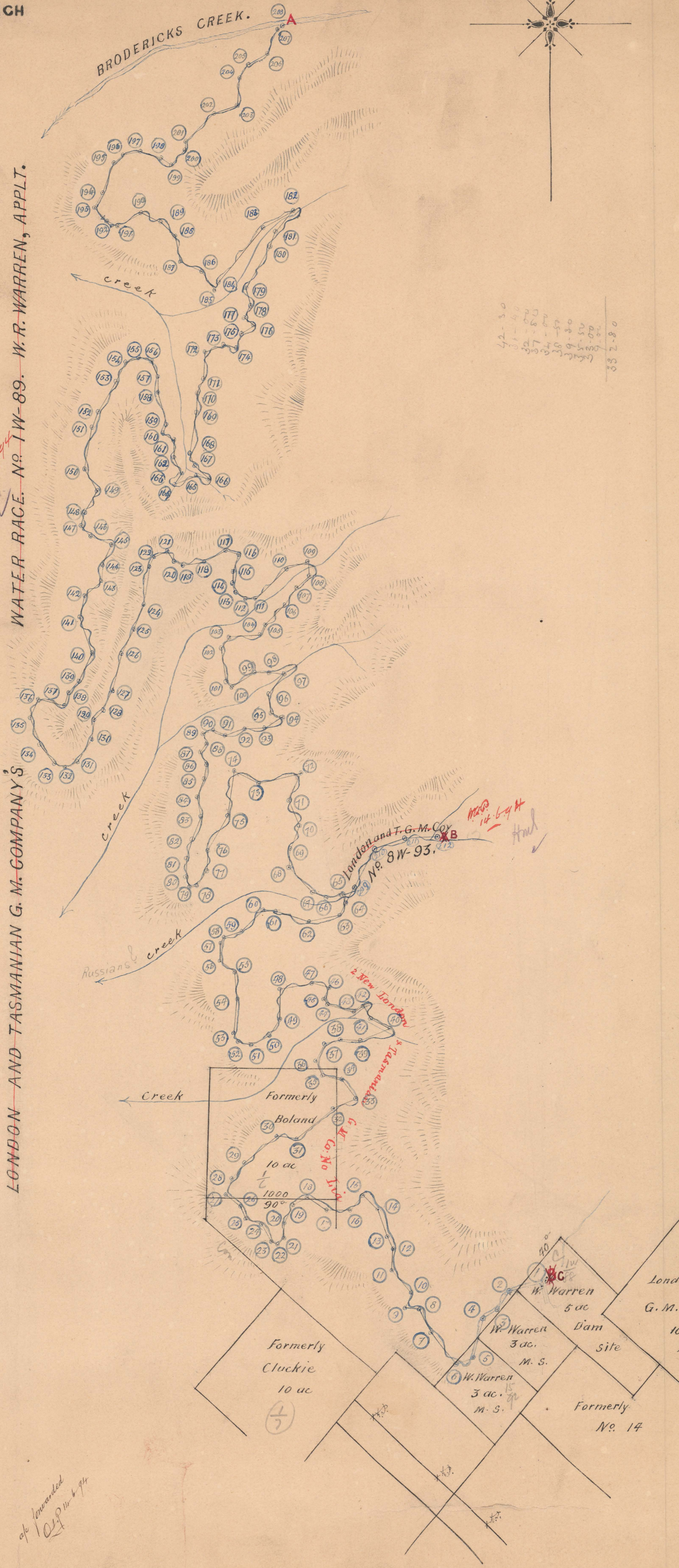
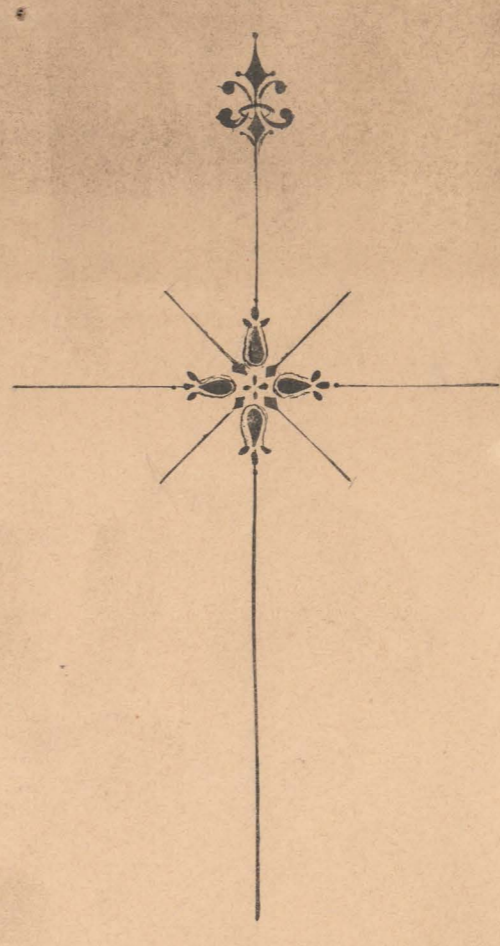
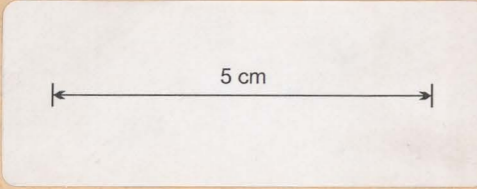

332-80
332-81
332-82
332-83
332-84
332-85
332-86
332-87
332-88
332-89
332-90

Back
JK
6.6.94

WATER RACE. NO. 1W-89. W.R. WARREN, APPLT.
LONDON AND TASMANIAN G. M. COMPANY'S

London and T. G. M. Co.
No. 8W-93

2 New Islands
1000-1001

Heavily timbered broken country
David Jones,
Mining Surveyor.
Waratah, April 26th 1897.
Plotted by C.P. 14.5.94.
Entered on general map by C.P. 18.5.94.
Finally examined by C.P. 21.5.94.

Tracing to Diagram
C.P. 12.5.94

of landward
C.P. 14.5.94

S.P.

London & Tasmania Co. Ltd.
Water Rights 89 & 93.

121.

W. RS. LONDON & TAS. G. M. CO.

