

394 (34)	394 (34)	394 (34)	394 (34)
387	387	387	387
400	400	400	400
324 48	324 48	324 48	324 48
(33)	(33)	(33)	(33)
(35)	(35)	(35)	(35)
372	372	372	372
301	301	301	301
227	227	227	227
77	77	77	77
359 35	359 35	359 35	359 35
(36)	(36)	(36)	(36)
307	307	307	307
71	71	71	71
89 35	89 35	89 35	89 35
(35)	(35)	(35)	(35)
480	480	480	480
452	452	452	452
53 2	53 2	53 2	53 2
(38)	(38)	(38)	(38)
508 (38)	508 (38)	508 (38)	508 (38)
431	431	431	431
280	280	280	280
57	57	57	57
52 47	52 47	52 47	52 47
(26)	(26)	(26)	(26)
41	41	41	41
52 21	52 21	52 21	52 21
(33)	(33)	(33)	(33)
1003	1003	1003	1003
399	399	399	399
379	379	379	379
829	829	829	829
560	560	560	560
178	178	178	178
359 35	359 35	359 35	359 35
(31)	(31)	(31)	(31)
164	164	164	164
90 0	90 0	90 0	90 0
(30)	(30)	(30)	(30)
262	262	262	262
199 35	199 35	199 35	199 35
(28)	(28)	(28)	(28)
197	197	197	197
83 31	83 31	83 31	83 31
(27)	(27)	(27)	(27)
984	984	984	984
371	371	371	371
327 52	327 52	327 52	327 52
(34)	(34)	(34)	(34)
1016	1016	1016	1016
317	317	317	317
588	588	588	588
390	390	390	390
43	43	43	43
322 37	322 37	322 37	322 37
(20)	(20)	(20)	(20)
230	230	230	230
30 0	30 0	30 0	30 0
(23)	(23)	(23)	(23)
153	153	153	153
359 47	359 47	359 47	359 47
(22)	(22)	(22)	(22)
1009	1009	1009	1009
208	208	208	208
89	89	89	89
52 58	52 58	52 58	52 58
(17)	(17)	(17)	(17)
631	631	631	631
282	282	282	282
359 40	359 40	359 40	359 40
210	210	210	210
270	270	270	270
(19)	(19)	(19)	(19)
851	851	851	851
634	634	634	634
230	230	230	230
143 3	143 3	143 3	143 3
(17)	(17)	(17)	(17)
1007	1007	1007	1007
340	340	340	340
630	630	630	630
340	340	340	340
232 30	232 30	232 30	232 30
(16)	(16)	(16)	(16)
159	159	159	159
360	360	360	360
(15)	(15)	(15)	(15)
391	391	391	391
350	350	350	350
270	270	270	270
72	72	72	72
(14)	(14)	(14)	(14)
231 35	231 35	231 35	231 35
(13)	(13)	(13)	(13)
1000	1000	1000	1000
317	317	317	317
575	575	575	575
(7)	(7)	(7)	(7)
391	391	391	391
752	752	752	752
142 52	142 52	142 52	142 52
(12)	(12)	(12)	(12)
140	140	140	140
(11)	(11)	(11)	(11)
30	30	30	30
(10)	(10)	(10)	(10)
328	328	328	328
68	68	68	68
302 12	302 12	302 12	302 12
(9)	(9)	(9)	(9)
902	902	902	902
548	548	548	548
360	360	360	360
(8)	(8)	(8)	(8)
1001	1001	1001	1001
896	896	896	896
230 30	230 30	230 30	230 30
(7)	(7)	(7)	(7)
392	392	392	392
888	888	888	888
700	700	700	700
20	20	20	20
(6)	(6)	(6)	(6)
142 58	142 58	142 58	142 58
(5)	(5)	(5)	(5)
935	935	935	935
725	725	725	725
351	351	351	351
(4)	(4)	(4)	(4)
1016	1016	1016	1016
280	280	280	280
323 16	323 16	323 16	323 16
(3)	(3)	(3)	(3)
997	997	997	997
633	633	633	633
300	300	300	300
(2)	(2)	(2)	(2)
1800	1800	1800	1800
(1)	(1)	(1)	(1)
1110	1110	1110	1110
1000	1000	1000	1000
580	580	580	580
338	338	338	338
270	270	270	270
(0)	(0)	(0)	(0)

FIELD NOTES

Date of instructions 23rd July 1892 (from Inspector Smith) See also B.A.P. 502
 Survey commenced 24th August 1892
 Survey finished 16th September 1892
 Plotted by
 Finally examined by
 Entered on General Plan by

Donald Fraser
 Mining Surveyor

4th Invoice
 23rd 08
 5-12-92 D.F.

370 chains 07 links by Field Notes

D.A.P. 19-11-92

Handwritten calculations and notes at the bottom of the page, including a list of numbers and some small diagrams.

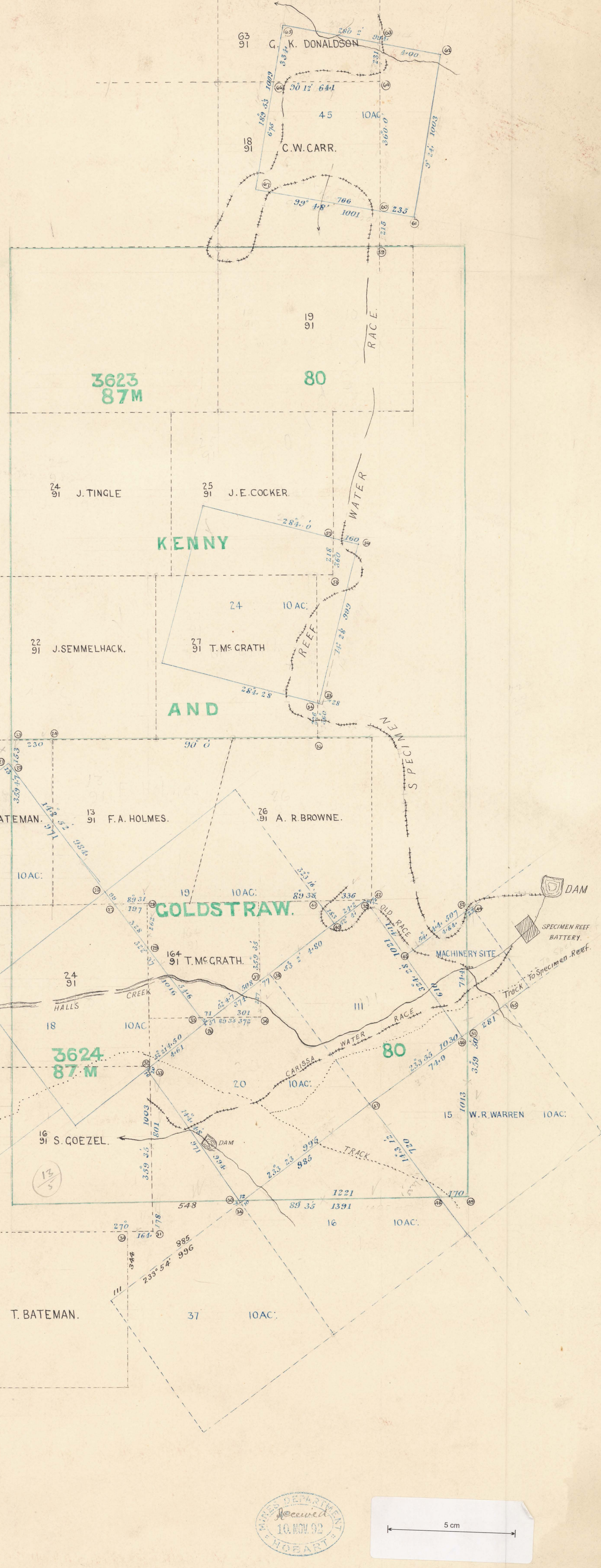

COUNTY OF RUSSELL.
 LOCALITY SPECIMEN REEF.

Scale 4 Chains to one Inch.

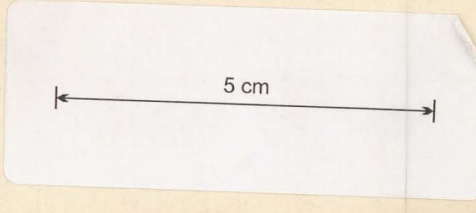

127. CONNECTION: SAVAGE RIVER
& SPECIMEN REEF. ^H

CONNECTION
SAVAGE RIVER

127