

MINERAL

COUNTY OF MONTAGU

Vicinity of Zeehan
Scale Five chains to an inch

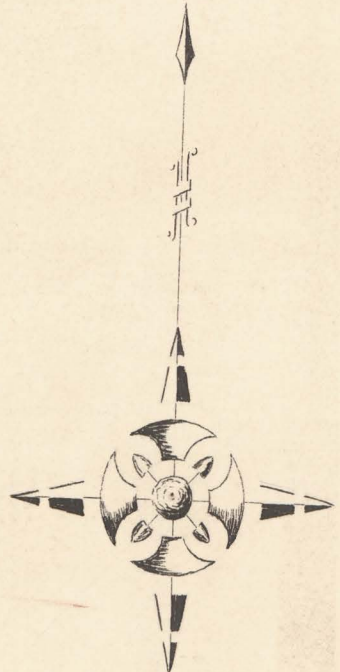

Field Notes filed *Q.P.* 9.11.01

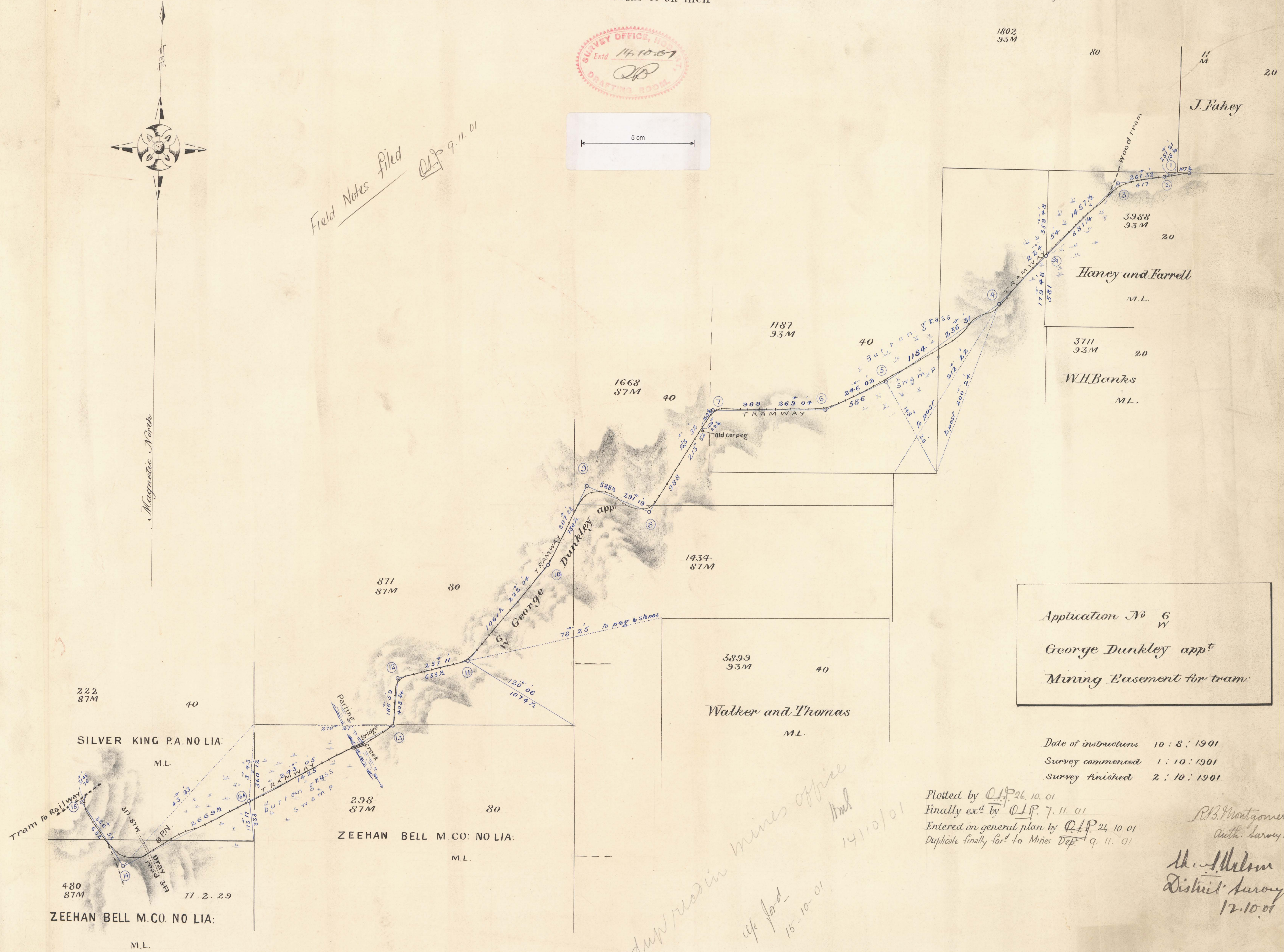
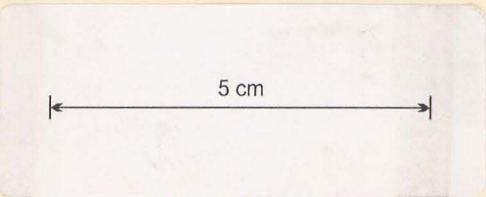

Application No 6
W
George Dunkley app^t
Mining Easement for tram:

Date of instructions 10 : 8 : 1901
Survey commenced 1 : 10 : 1901
Survey finished 2 : 10 : 1901

Plotted by *Q.P.* 26. 10. 01
Finally ex^d by *Q.P.* 7. 11. 01
Entered on general plan by *Q.P.* 24. 10. 01
Duplicate finally for^d to Mines Dep. 9. 11. 01

R.B. Montgomery
Auth. Surveyor
W. Nelson
District Surveyor
12.10.01

*dup res in mines office
14/10/01
4/6 for
15-10-01*

S.P
130-01

Mining Easement No 6
Geo: Dunkley appf
ZEEHAN

PLAN
130

ORIGINAL

Mining Easement No 6
Geo: Dunkley appf
ZEEHAN

REPRODUCED FROM ORIGINAL