

# PLAN

## SHEWING MACHINERY SITE RACE

### AND

## CONTOUR OF PROPOSED WEIR

# HEEMSKIRK RIVER.

SCALE 3 CHAINS TO 1 INCH.

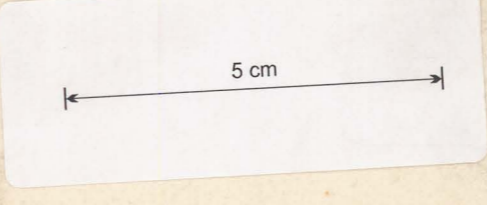

REFERENCE TO TRAVERSE					
Line	Bearing	Distance	Line	Bearing	Distance
1	194° 26'	50.75	10	171° 26'	62.25
2	236° 50'	120.50	11	93° 47'	171
3	210° 42'	75.25	12	98° 58'	363
4	202° 46'	261.25	13	97° 35'	391
5	202° 5'	169	14	62° 58'	50.5
6	308° 23'	185	15	62° 40'	193
7	308° 15'	287.5	16	40° 38'	116.75
8	308° 12'	136.5	17	38° 3'	286
9	242° 16'	253	18	42° 25'	350.5
10	112° 44'	230.75	19	43° 17'	220.5
11	217° 44'	59.75	20	64° 57'	174
12	228° 15'	134.75	21	77° 8'	509
13	226° 56'	310	22	85° 51'	192
14	159° 5'	109.5	23	59° 49'	349.5
15	178° 45'	319.75	24	27° 47'	51.5
16	141° 57'	322.25	25	27° 12'	49.5
17	137° 45'	283.25	26	62° 37'	238
18	133° 17'	917.25	27	11° 43'	223
19	176° 17'	119	28	5° 15'	92.75
20	174° 41'	316.5	29	7° 11'	151.75
21	161° 30'	115	30	332° 41'	159
22	108° 48'	230	31	363° 38'	247.5
23	220° 40'	106.75	32	388° 37'	342.75
24	218° 23'	220.50	33	85° 46'	154.5
25	183° 29'	201	34	341° 1'	315.75
26	227° 32'	249	35	302° 11'	227.5
27	230° 35'	182.5	36	302° 44'	300
28	27° 53'	120.25	37	302° 45'	204
29	236° 35'	99	38	75° 41'	457.75
30	247° 23'	166	39	82° 59'	194
31	237° 26'	306	40	74° 30'	199.5
32	24° 56'	295	41	117° 1'	283.25
33	214° 56'	333.25	42	61° 36'	265.75
34	218° 11'	232.5	43	320° 8'	189
35	245° 2'	187.5	44	41° 27'	105.5
36	263° 29'	120	45	30° 18'	112.75
37	268° 27'	208	46	40° 02'	269.5
38	272° 26'	313.50			
39	273° 49'	264			

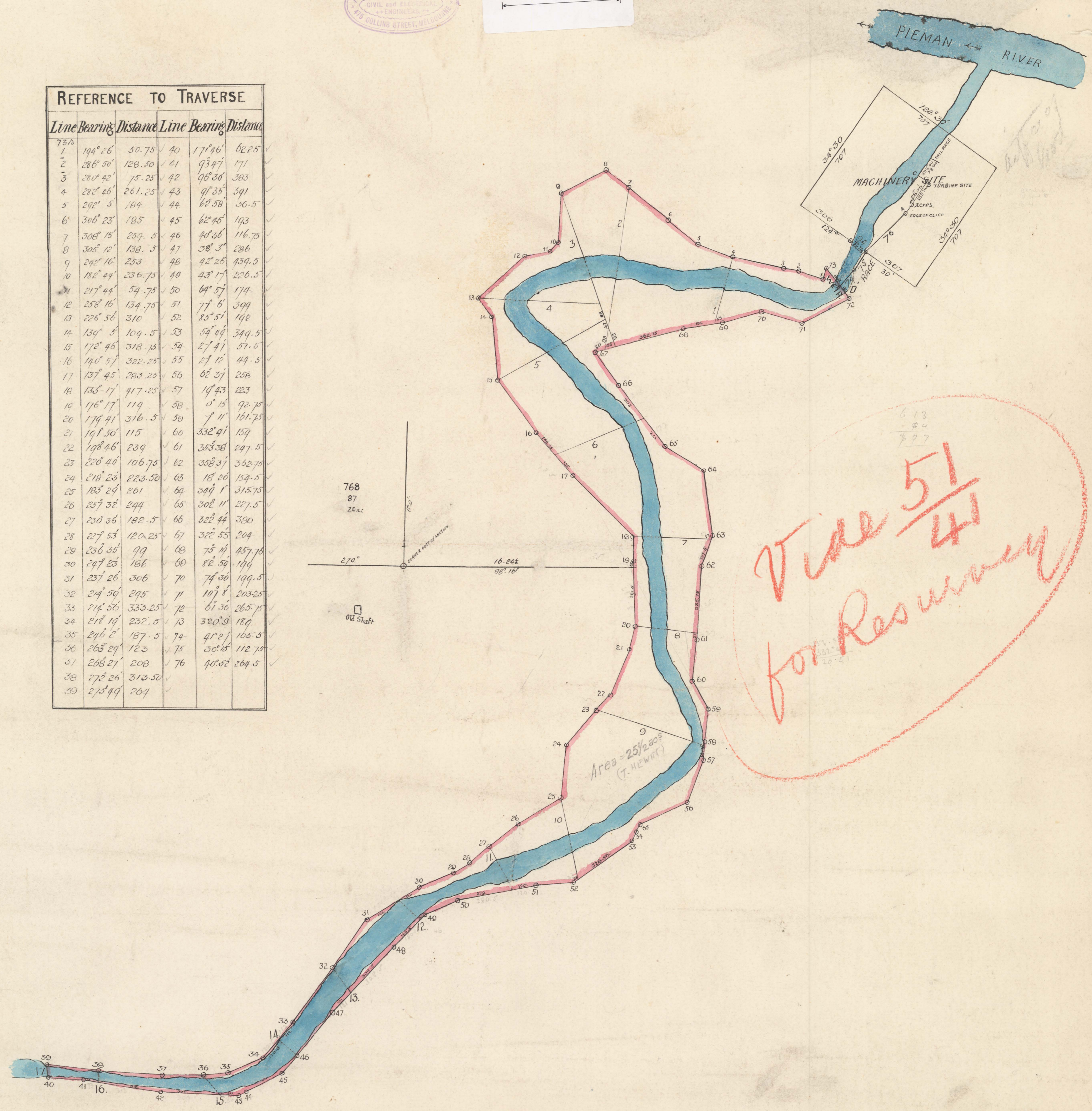

Tide 51/41  
for Resurvey

J. J. J. J.  
Auth. Surveyor  
Leehan.  
6/10/11

AUSTRALIAN RIGHTS PURCHASING ASSOCIATION  
Hemby Rivers

138

**138. AUSTR. RIGHTS PUR. ASSN.**

Handwritten scribbles and marks at the bottom of the page.