

SURVEY OFFICE, HONG KONG
22.3.99
DRAFTING ROOM

MINERAL

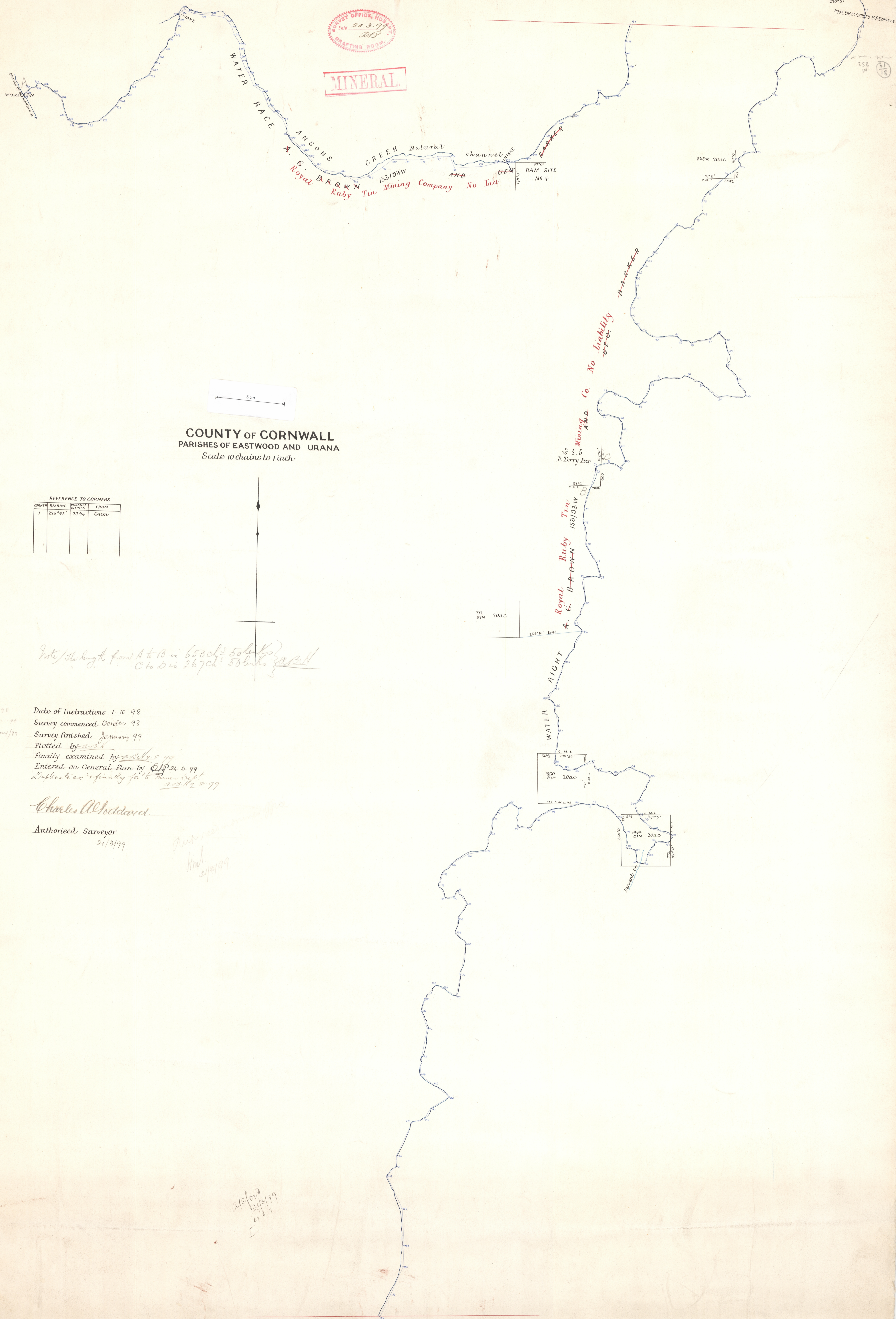

COUNTY OF CORNWALL
PARISHES OF EASTWOOD AND URANA
Scale 10 chains to 1 inch

REFERENCE TO CORNERS

CORNER	BEARING	DISTANCE IN CHAINS	FROM
1	225° 45'	73-7/8	Gum

Note: The length from A to B is 653 ch = 506 links
C to D is 267 ch = 506 links

Date of Instructions 1.10.98
Survey commenced October 98
Survey finished January 99
Plotted by [signature]
Finally examined by [signature] 8.99
Entered on General Plan by [signature] 21.3.99
Duplicate set finally for the Times Dept
[signature] 8.99

Charles Alford
Authorised Surveyor
21/3/99

[Handwritten notes and signatures]

[Handwritten notes]