

S.P.
147-06

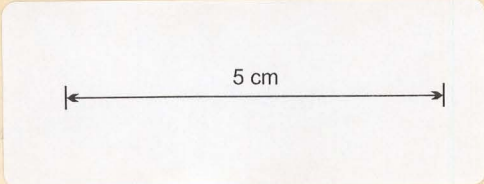

DIAGRAM FROM ACTUAL SURVEY

22-11-99
S. P.
147-06

20 ac.
COUNTY OF Dorset
Hen Kee
Appt.
PARISH OF Moorina

REFERENCE TO CORNERS.

CORNER	BEARING	DISTANCE IN LINKS	FROM

Scale four chains to an inch.

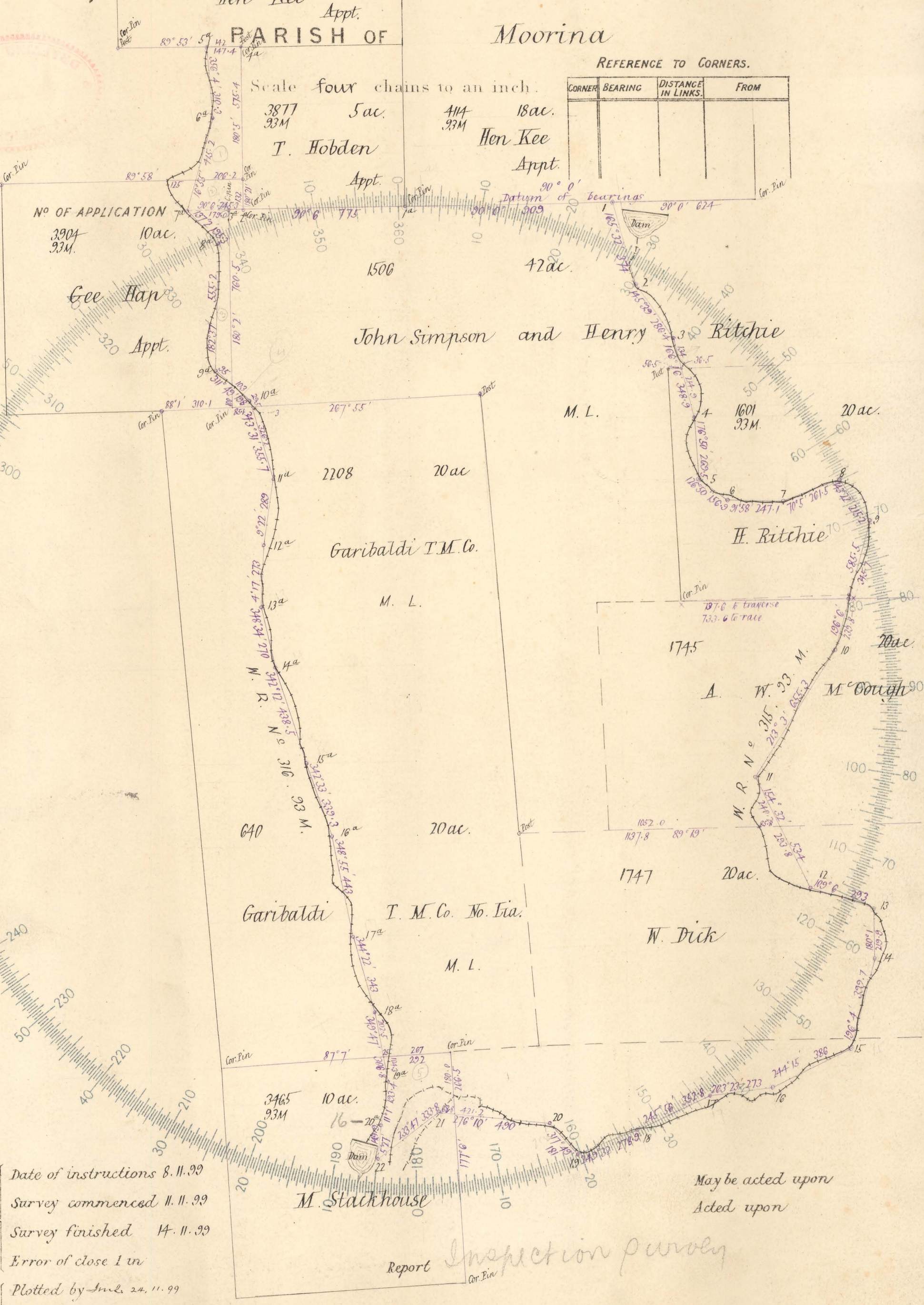

Nº OF APPLICATION
3904
93M.

60-300
70-290
80-280
90-270
80-260
70-250
60-240
50-230
40-220
30-210
20-200
10-190
0-180
10-170
20-160
30-150
40-140
50-130
60-120
70-110
80-100
90-90
100-80
110-70
120-60
130-50
140-40
150-30
160-20
170-10
180-0
190-10
200-20
210-30
220-40
230-50
240-60
250-70
260-80
270-90
280-100
290-110
300-120

To be filled in
by Surveyor
Office
examination

- Date of instructions 8.11.99
- Survey commenced 11.11.99
- Survey finished 14.11.99
- Error of close 1 in
- Plotted by Insl. 24.11.99
- Finally examined by
- Entered on General Plan by

Maybe acted upon
Acted upon

Report Inspection purely

25/11/99
5/12/99

H.M. Chish
District Sur
20.11.99
S.P.
147-06

