

PLAN OF SURFACE WORKINGS ON THE MAJOR G. M. CO.'S LODES

Scale of chains.

After Montgomery

REFERENCE

- A. Old shaft about 70 f. deep
- B. " " " 50 " "
- C. " " over 30 " "
- D. " " 30 " "
- E. " " about 30 " "
- F. " " over 50 " "
- G. " " much filled up
- H. " " about 12 f. deep
- K. " " 22 f. 6 inches "
- L. " " 32 feet "
- M. Hole 5 or 6 f. deep
- N. Old 6' x 3' centred shaft
- O. Birketts shaft 35 f. deep
- P. Old shaft 40 f. or more
- Q. Major Eastern shaft 6 f. x 3 f.
- R. Shaft 12 f. deep
- S. 6' x 3' underlay shaft 22 f. deep
- T. Shaft 12 feet deep
- U. " 11 f. 6 in "
- V. Old shaft 32 f. deep
- W. " " 22 f. 6 in deep
- X. " " about 20 f. deep
- Y. " " 60 f. deep
- Z. " " South reef filled up
- a. West Major shaft about 50 f. deep
- b. Old shaft 30 feet deep
- c. " " 47 " "

○ Figures in circles denote approximate heights above sea level taken with aneroid barometer.

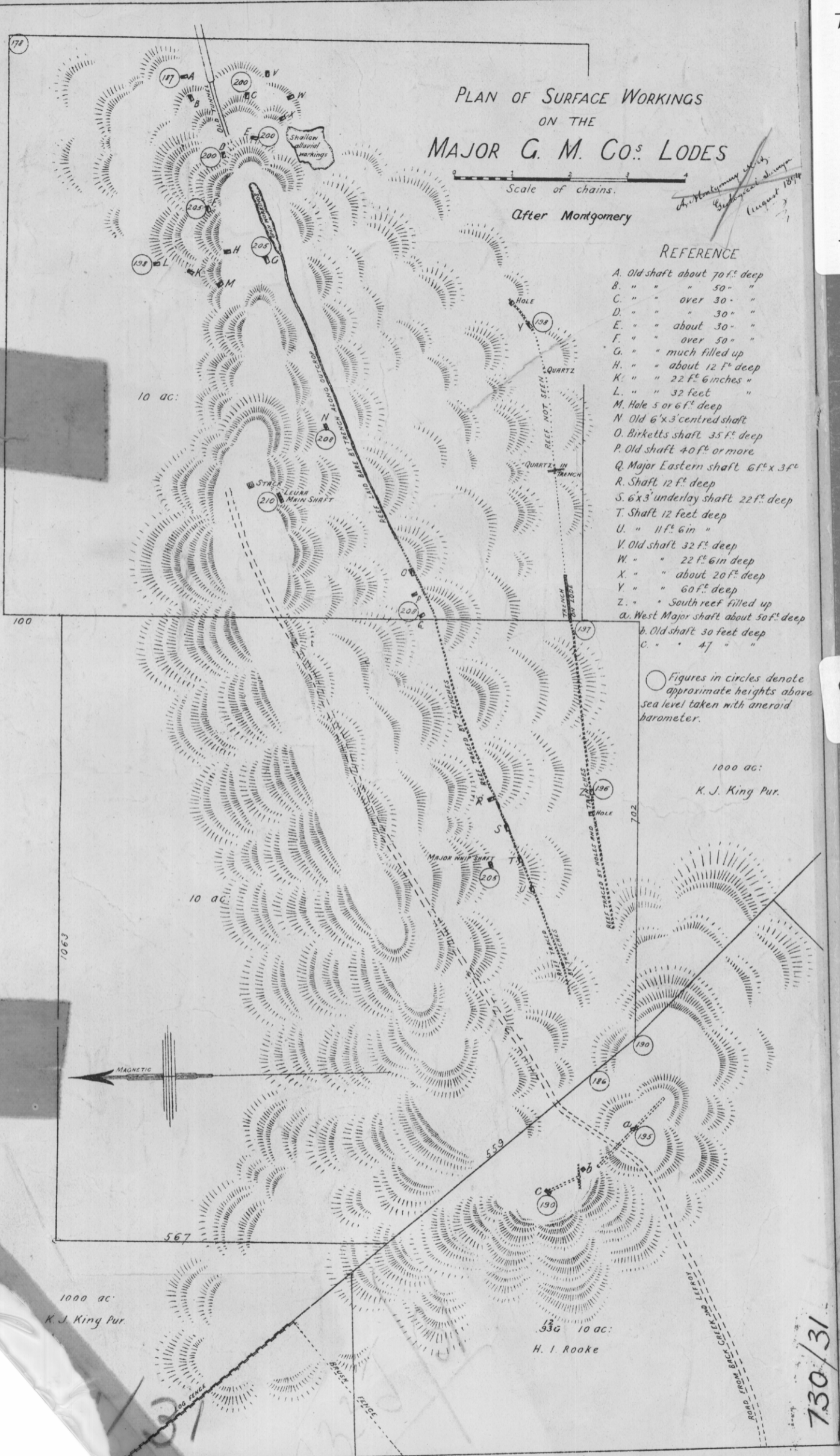

5 cm

66

730

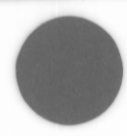

730/31