

liv

I have the honour to forward herewith diagram of W.R. N^o. 695 applied for by the Royal Ruby I.M. Co. Notice as an extension of W.R. N^o. 69.

The water^W Right passes over the following mineral bases = 10 ac N^o. 145^M & 10 ac N^o. 1552^M₉₃
Royal Ruby I.M. Co. M.L. 10 ac N^o. 5323^M₉₃, 40 ac N^o. 1999^M₃₁, 40 ac 4284^M₉₃, 10 ac 5279^M₉₃ & 10 ac N^o. 497^M Thureau Deep Lead I.M. Co. N^o. Tie.

and over 20 ac N^o. 4463^M₉₃ A. Deedes M.L.
It also passes over 500 ac lot recently applied for to purchase by Duncan D. Mc Nab. The race has been reserved through this lot.

From a point near traverse station N^o. 6 to a point between traverse stations N^o. 24 & 26 on section N^o. 4284^M₉₃, 40 ac. the water right follows the course of an old race channel formerly used by the Thureau Deep Lead I.M. Co. This old race has never been leased and has not been in use

since survey of W.R. d^o 623 w the latter
bringing the same water in ⁹³ at a higher
level.

The water right applied for passes under
W.R. d^o 623 w Thereau Sab Lead S. M. b. M. L
at a ⁹³ point ~~o~~ where the latter is carried
in fluming. It also passes under
the Main Road from St. Helens to Goulds bounting
the necessary culvert having been provided
at the crossing place

G. A. Counsel Esq^r
Surveyor General

I have the honour
to be,
Sir,

Your obedient servant
Isaac Campbell Smith
Auth^r Surveyor.

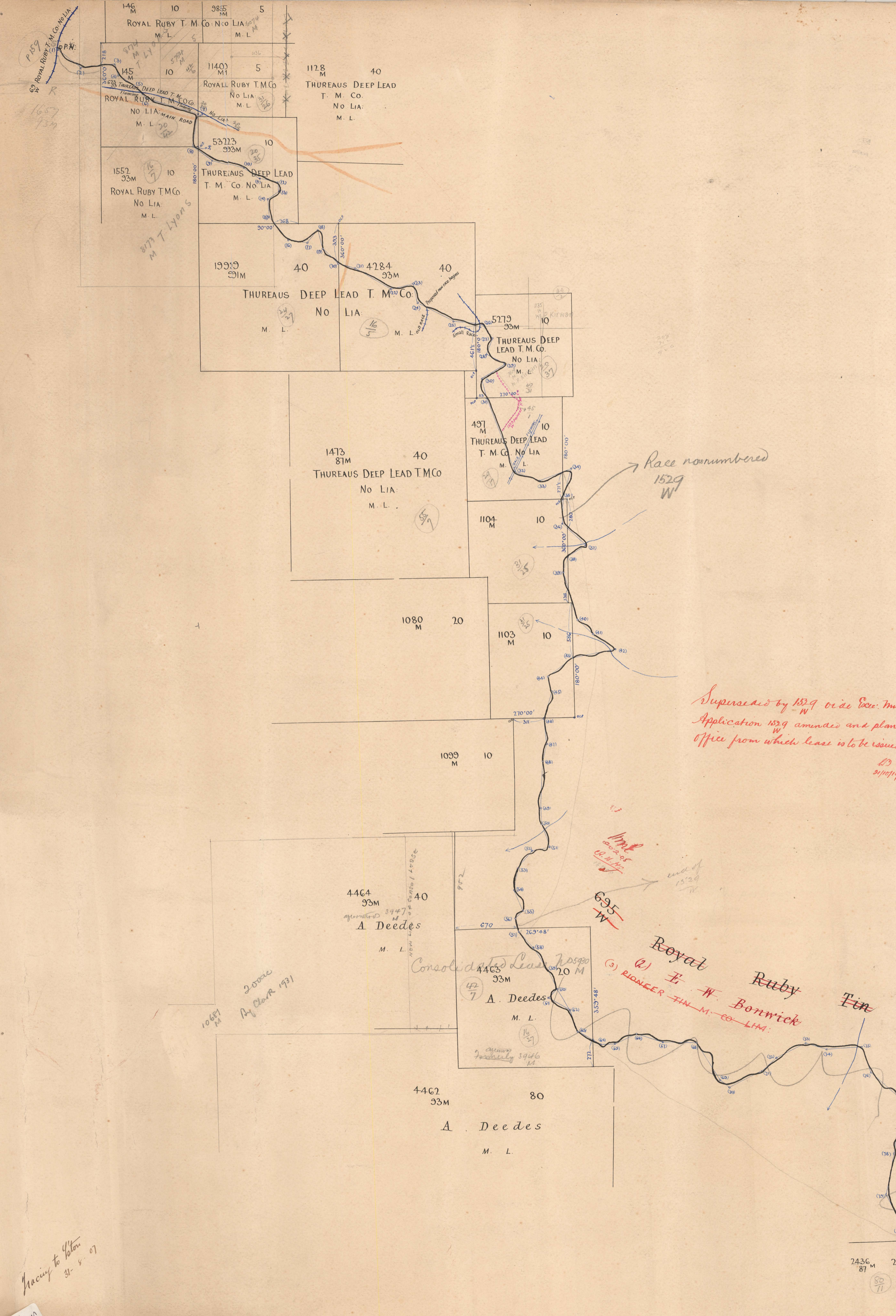

MINERAL

COUNTY OF CORNWALL
PARISH OF EASTWOOD

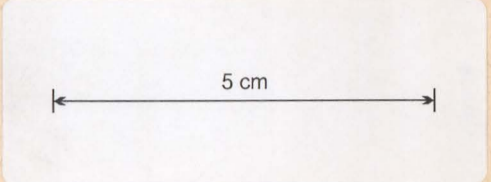

Scale: - 5 chains to an in: -

Date of instructions 11. 12. 1906
Survey commenced 1. 3. 1907
Survey finished 29. 7. 1907
Plotted by [Signature] 19. 9. 07
Finally ex-^d by [Signature] 29. 9. 07
Entd on Plan by [Signature] 31. 8. 07

W. Campbell Smith
Authorized Surveyor

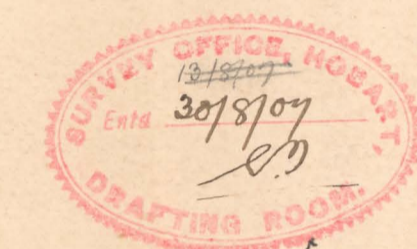

May be acted upon [Signature] 21. 10. 07

NOTE - PERMANENT OFFICE ALTERATIONS AND ADDITIONS SHOWN IN RED

See for Mines refuses to accept [Signature]

Awaiting further information vide letter 14. 8. 07 [Signature]

Length = 400 chains +

Superseded by 1529 vide Sec. Min. 23 16/9/09
Application 1529 amended and plan drawn in office from which lease is to be issued [Signature]

10/11/07 [Signature]

695 [Signature]

Royal Ruby Tin Mining Company
(1) F. W. Bonwick
(2) PLANCER TIN M. CO. LIA

Extension of 69 [Signature]

Applicant
Mining Act 1905
Duncan Donald M^c Nab App^t

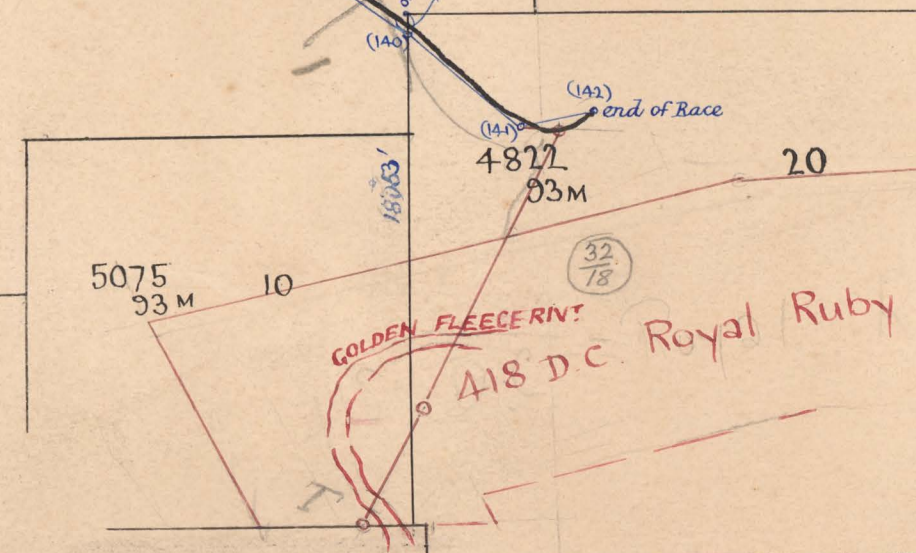

Accy to plan 31. 8. 07

101

155-01

163. 695. ROYAL RUBY T. M. CO.
W.
PIONEER T. M. CO.

695
W
Royal Ruby T. M. Co

163