

DONALD FRASER,  
SURVEYOR AND ENGINEER.

Dorset, 28<sup>th</sup> August 1907

Report on 773 - New Aberfoyle Tin Mining Co. No Lia.  
Appt for 1 sluice-head from Hardwick's Creek  
under "The Mining Act, 1905".

1. No part passes over or encroaches upon land occupied by or belonging to any person other than Applicants.
2. Part crosses over Main Road from Gladstone to Borbyalla. No part passes over or encroaches upon any public road or other Water Right or work connected with Mining.
3. Applicants have constructed a Dam on part of race. If applicants intend to continue to use this Dam they should apply for about 2 acres Dam site.

Donald Fraser  
Auth<sup>d</sup> Surveyor.

The Surveyor General  
Survey Office  
Hobart

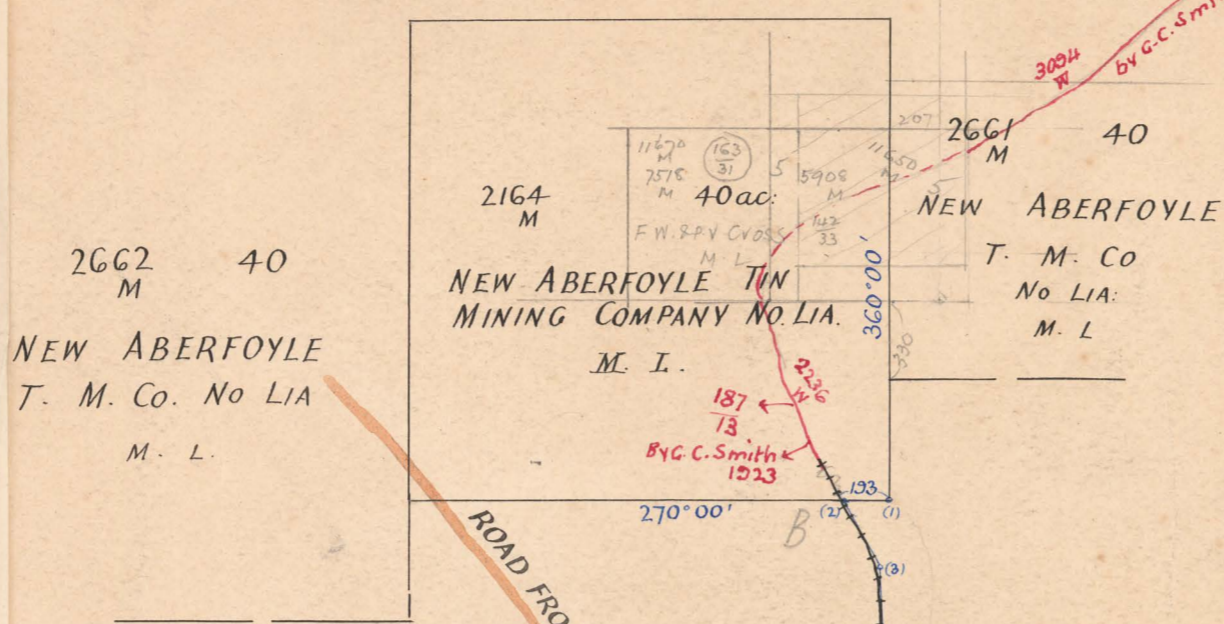

Length A to B 6 miles +-

MINERAL

COUNTY OF DORSET  
PARISH OF WOUREDDY

Scale: 8 chains to one inch

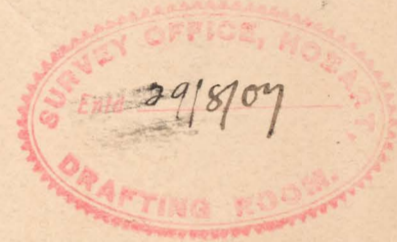

Donald Fraser  
Auth. Surveyor

1907

W.H.W.  
17.2.08

W.H.W.

Date of Instructions 30<sup>th</sup> May 1907  
Survey commenced 12<sup>th</sup> July 1907  
Survey finished 15<sup>th</sup> July 1907

Plotted by O.L.F. 13.9.07  
Finally examined by J.P. 29.8.07  
Ent<sup>d</sup> on Gen<sup>l</sup> Plan by O.L.F. 30.8.07

May be acted upon 21-10-07



Tracing to Station  
30.8.07

S.P.  
164-01

P 164

S.P.  
164-01

*[Faint handwritten notes on a separate sheet of paper, partially obscured and illegible.]*

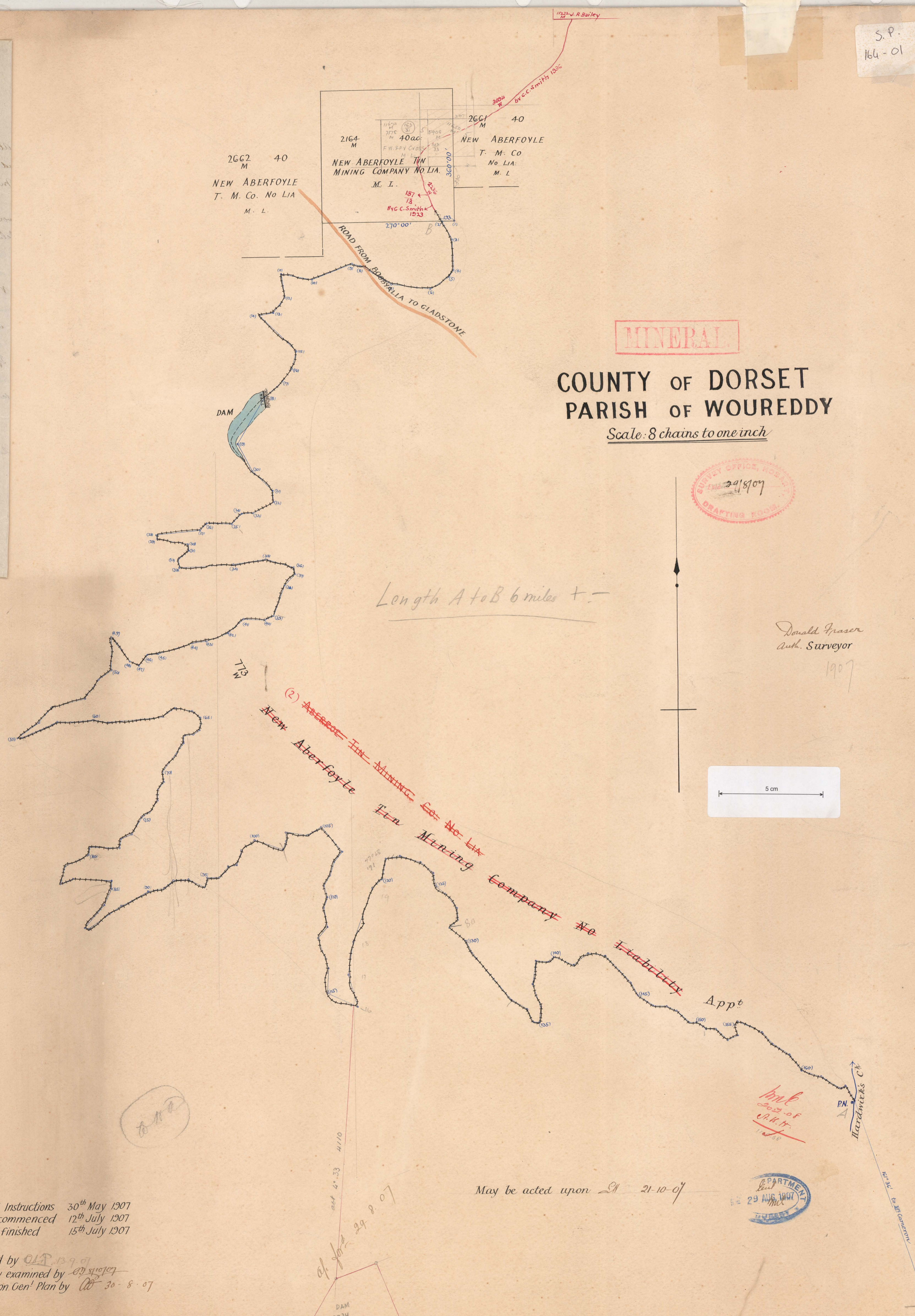

Length A to B 6 miles + -

total  
17.2.08

|                      |                            |
|----------------------|----------------------------|
| Date of Instructions | 30 <sup>th</sup> May 1907  |
| Survey commenced     | 12 <sup>th</sup> July 1907 |
| Survey finished      | 15 <sup>th</sup> July 1907 |

|                        |               |
|------------------------|---------------|
| Plotted by             | OLP 1399      |
| Finally examined by    | Johns 29/8/07 |
| Ent'd on Gen'l Plan by | OLP 30-8-07   |

May be acted upon 21-10-07

DEPARTMENT OF  
29 AUG 1907

S.P.  
164-01

New Aberfoyle T. M. Co.

W  
773

164. 773. ABERROE T. M. CO.  
W.

