

COUNTY OF RUSSELL

Vicinity of Mount Farrell
Scale 6 chains to an Inch
Date of Instructions 15.7.08
Date of Survey 12 to 15.8.1908
Charted *at* 7.9.08
Plotted *at* 7.9.08
Examined by 5.9.08

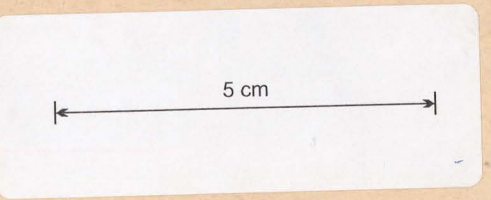

May be acted upon *of* 14.12.08



Length = 280 chains +
10
290 A & B X

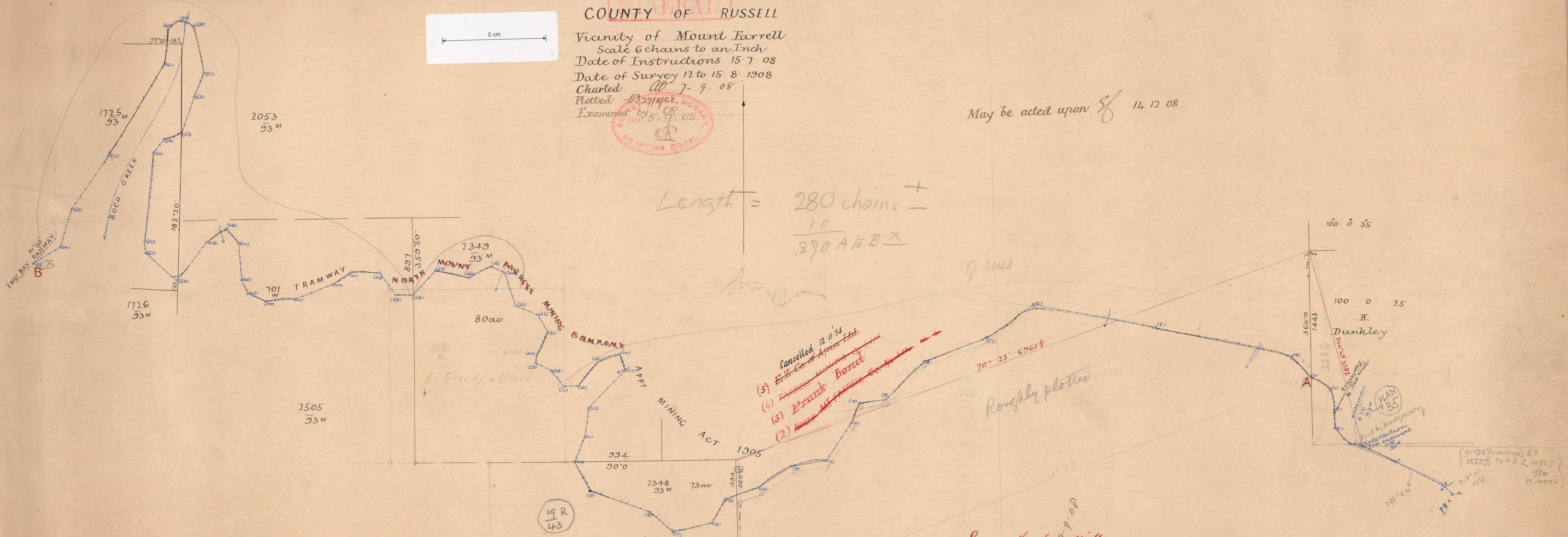

Roughly plotted

- (5) Cancelled 12.11.14
H. Z. Co. of Apaco Ltd.
- (4) ~~FARRELL MINING~~
- (3) ~~Frank Board~~
- (2) ~~Mount Farrell & North~~

19 R
43

Formerly *W. J. Heaps*
11.2.09
cl. H. J.

Reserve 1/2 chain wide
W. J. Heaps
9-00



H. Wilson
District Surveyor

*Facing to 4/10
7-9-*

S.P.
176-01

176

NORTH MT FARRELL M. CO

701

176

176.

701.

W.

N.MT. FARRELL M.CO.