

MINERAL

MONTAGU VICINITY OF MT READ

Scale 6 Chains to an Inch
Plan and Report from (1) to Y
Plan from survey from (1) to 13

Date of Instructions 7 3 08
Date of Survey from 8 to 10 6 08
Plotted & compared 27/1/08
Finally examined 27/1/08
Charted 27 7 08



May be acted upon 11/12/08 08

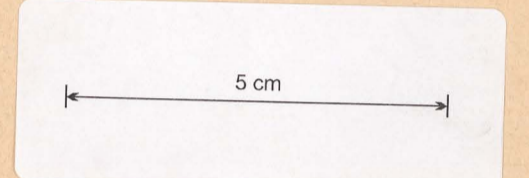

Report: - 886 to. to Right
prop. landowner applicant.
Mount Read

The regulations relating to marking off have been complied with.

No lands held under lease or other tenure is proposed over by this lot. No other lot or work connected with mining is encroached upon.

The park track to Mt. Read also the old park track from Dundas to Mt. Read is crossed by this lot.

The intrusion (survey) brings the race into the watershed of the Severn Riv. It may be stated that the applicant holds a lot for 5 three heads (No 827 to) on from the Severn Riv.

M. Wilson
Mining Surveyor
11.6.08



0 310.0
0 312.0
0 314.36
0 316.0
0 318.0
0 319.01
0 320.0
0 321.0
0 322.0
0 323.35
0 324.0
0 325.0
0 326.0
0 327.0
0 328.0
0 329.0
0 330.0
0 331.0
0 332.0
0 333.0
0 334.0
0 335.0
0 336.0
0 337.0
0 338.0
0 339.0
0 340.0
0 341.0
0 342.0
0 343.0
0 344.0
0 345.0
0 346.0
0 347.0
0 348.0
0 349.0
0 350.0
0 351.0
0 352.0
0 353.0
0 354.0
0 355.0
0 356.0
0 357.0
0 358.0
0 359.0
0 360.0
0 361.0
0 362.0
0 363.0
0 364.0
0 365.0
0 366.0
0 367.0
0 368.0
0 369.0
0 370.0
0 371.0
0 372.0
0 373.0
0 374.0
0 375.0
0 376.0
0 377.0
0 378.0
0 379.0
0 380.0
0 381.0
0 382.0
0 383.0
0 384.0
0 385.0
0 386.0
0 387.0
0 388.0
0 389.0
0 390.0
0 391.0
0 392.0
0 393.0
0 394.0
0 395.0
0 396.0
0 397.0
0 398.0
0 399.0
0 400.0

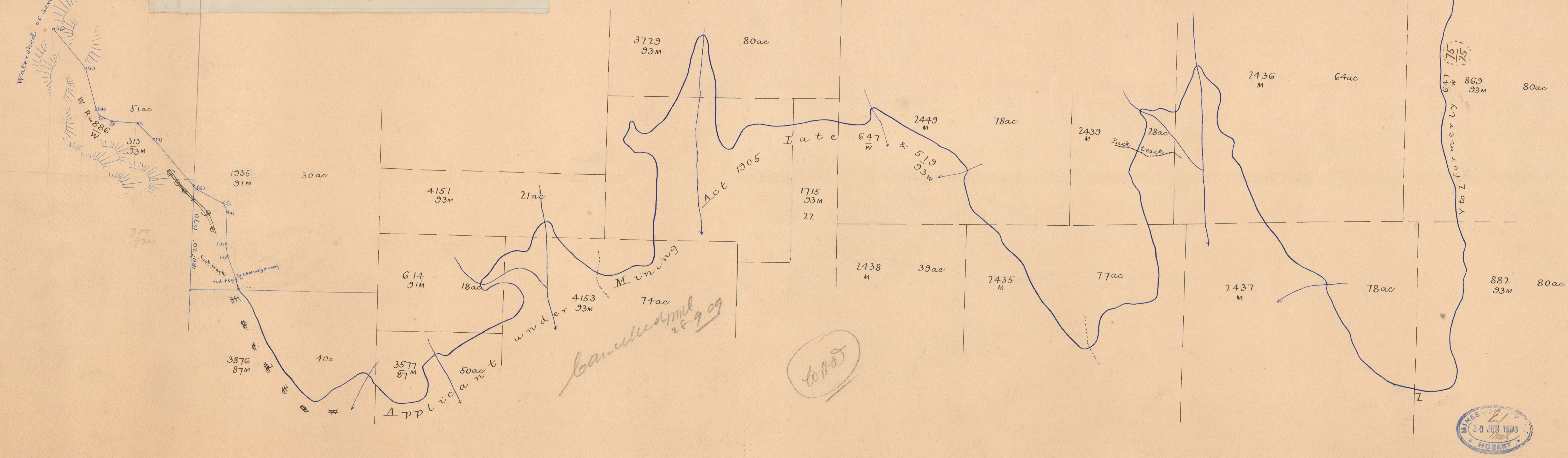
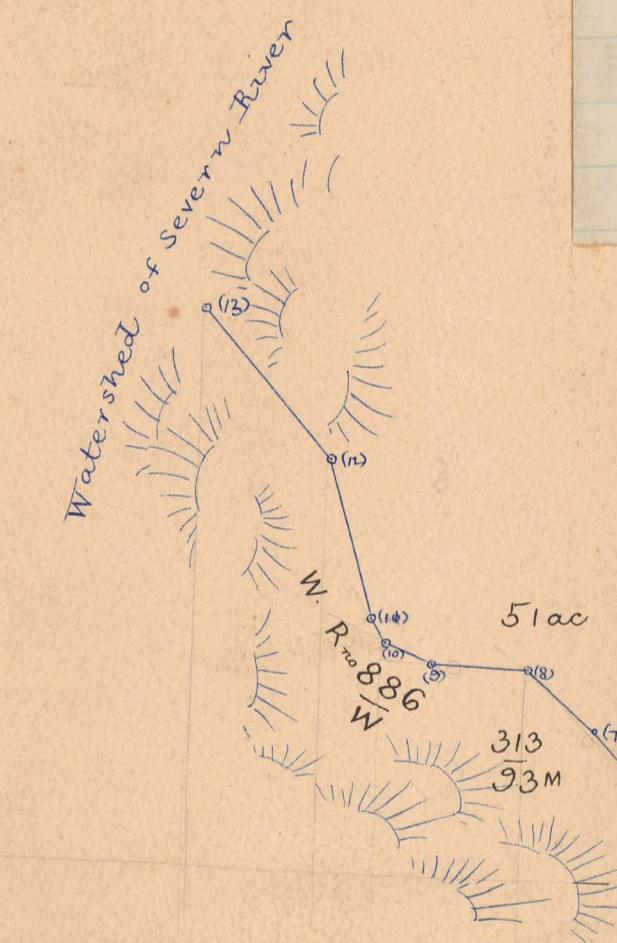

M. Wilson
District Surveyor
Tracing to L. Ton 17/08



S.F.
H.T.-01
old plan
containing the terms of
the Mt. Read
prop. landowner
Field No. of survey of extension of lot

77

177. 886. G. LAIDLAW.
W.

886 George Laidlaw
M

177