

10793 M
The Holdfast Gold Mines of No Lia.

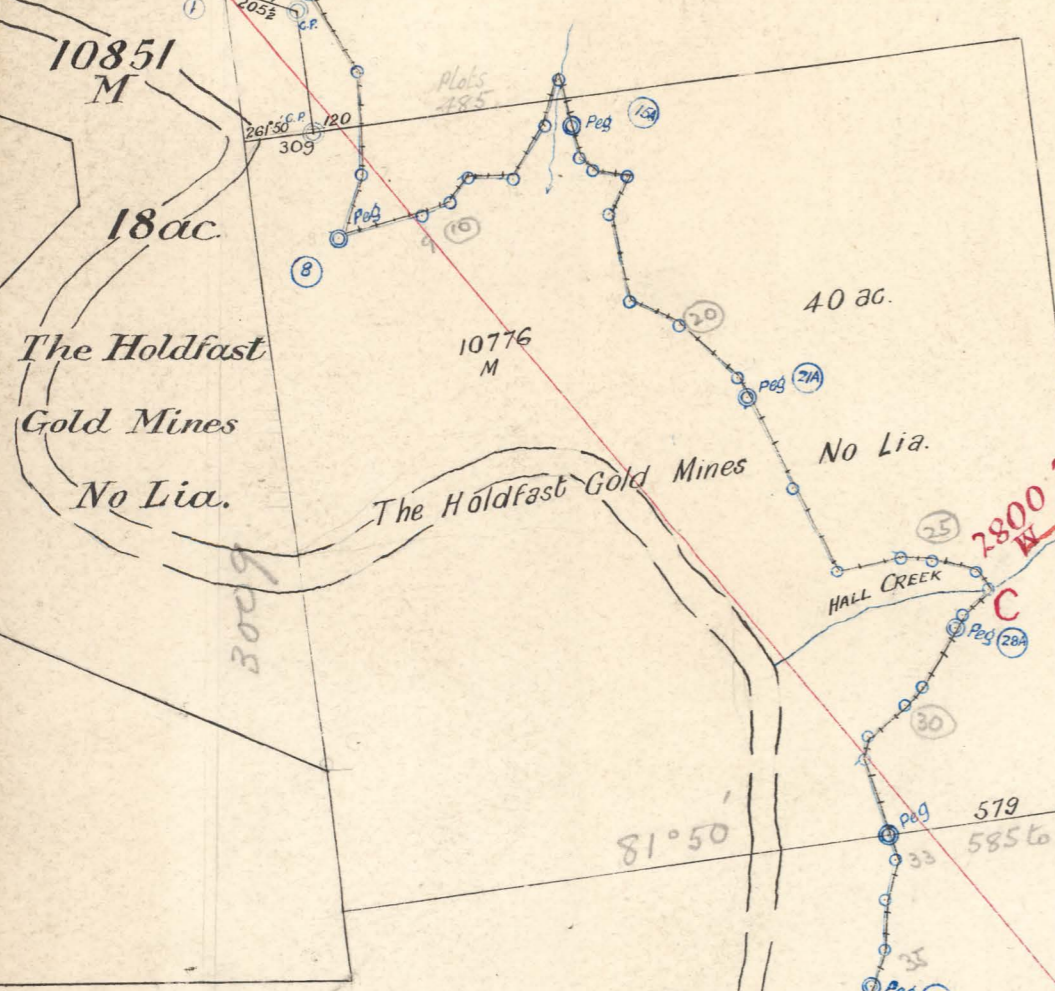

COUNTY OF RUSSELL
VICINITY OF ROCKY RY
PARISH OF

Scale 5 chains to an inch



REFERENCE TO CORNERS

COR.	BEARINGS	DISTANCE IN LINKS	FROM
8	60° 0'	28.4	Blwd
15A	345° 16'	100.3	Leatherwood
28A	46° 10'	38.5	Myrtle
35A	194° 42'	129.4	" Stp.
41A	159° 14'	20.4	" "
53	278° 28'	35.4	" "
59A	20° 0'	39.8	" "
67	286° 0'	14.6	" "
76A	8° 21'	200.8	" "
88	153° 41'	55.0	" "
109	223° 53'	35.0	Leatherwood
139	315° 11'	27.6	Myrtle
158	119° 0'	14.0	" Stp.
167	350° 0'	25.6	" "
186	41° 0'	25.0	" "
145	249° 0'	54.7	Pine Stump
171	133° 30'	110.0	Leatherwood Stc

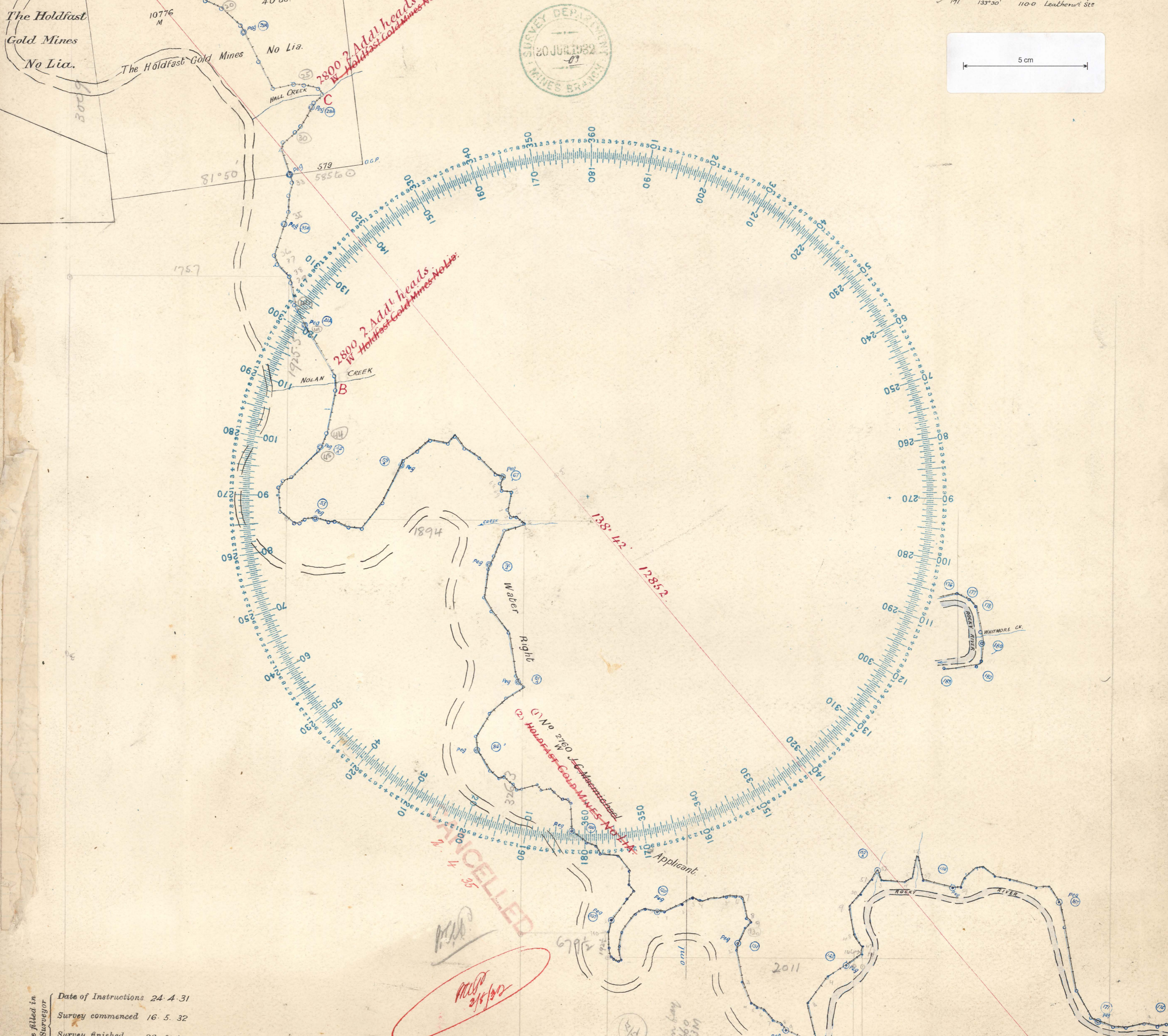
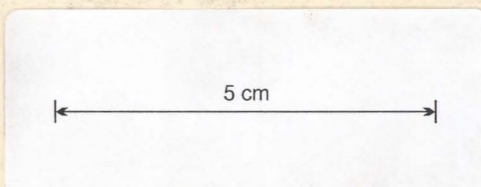

To be filled in by Surveyor
Date of Instructions 24.4.31
Survey commenced 16.5.32
Survey finished 28.5.32
Error of close 1 in

Office examination
Plotted by
Finally examined by 14/7/32
Entered on General Plan by 30-6-32
Tracing to Launceston 14/7/32

Report
Approved 1/7/32
Approved 7-13-32

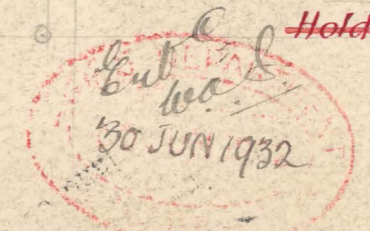

2761 J.C. Macmichael
W 5 Add'l heads
Holdfast Gold Mines No Lia.

Donald Fraser
Auth Surveyor.

S.P.
193-01

2760 2761,2800
W
W
(1) J.C. MACMICHAEL
(2) HOLDFAST GOLD MINES

2760 2761,2800
W W W
(1) J.C. MACMICHAEL
(2) HOLDFAST GOLD MINES