

COUNTY OF CORNWALL
VICINITY OF SOUTH GEORGES BAY
PARISH OF

Scale 10 chains to an inch

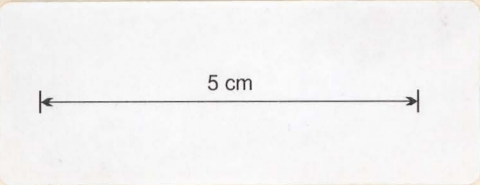

REFERENCE TO CORNERS

COR.	BEARING	DISTANCE IN LINKS	FROM
16	68° 57'	12.3	STump
52	Cor cut	on Stump (12")	
58	30° 20'	3.9	Iron Bark
70	33° 15'	4.7	STump
76	27° 40'	42.3	Iron Bark

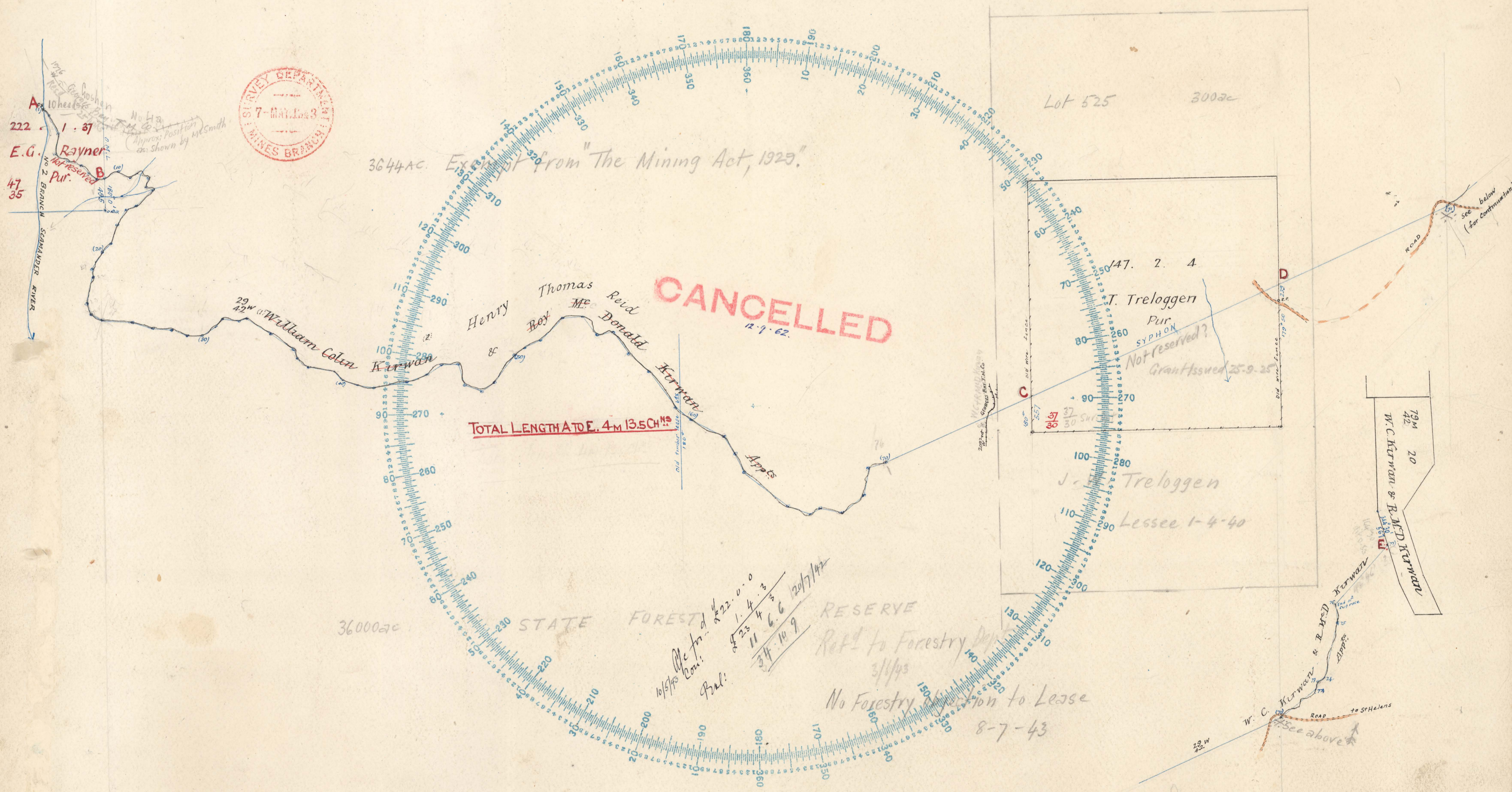

To be filed in
by Surveyor

Date of Instructions 7. 10. 42
Survey commenced 6. 4. 43
Survey finished 12. 4. 43
Error of close 1 in

Office examination

Plotted by A.G.C. 28/1/43
Finally examined by P.P. 31-5-43
Entered on General Plan by P.P. 11-5-43

Report



Campbell Smith
District

S. P.
202-01

May be acted upon 10-6-43
Acted upon W.A.S. 9-9-43

Nº 202 - 29w Kirwan W.C. & R.M. & D.
42

Nº 202 - 29w Kirwan W.C. & R.M. & D.
42

202