

CANCELLED 8-7-83

LAND DISTRICT OF KING ISLAND
VICINITY OF SEA ELEPHANT BAY

CONS'D. LEASE

5M 1840.
73

KIBUKA MINES PTY. LTD. APPT.

SUBJECT TO SURVEY

TRANSFERRED
1: BUKA MINERALS PTY. LTD.

REFERENCE CHARTS
SEA ELEPHANT RIVER
FRAZER RIVER

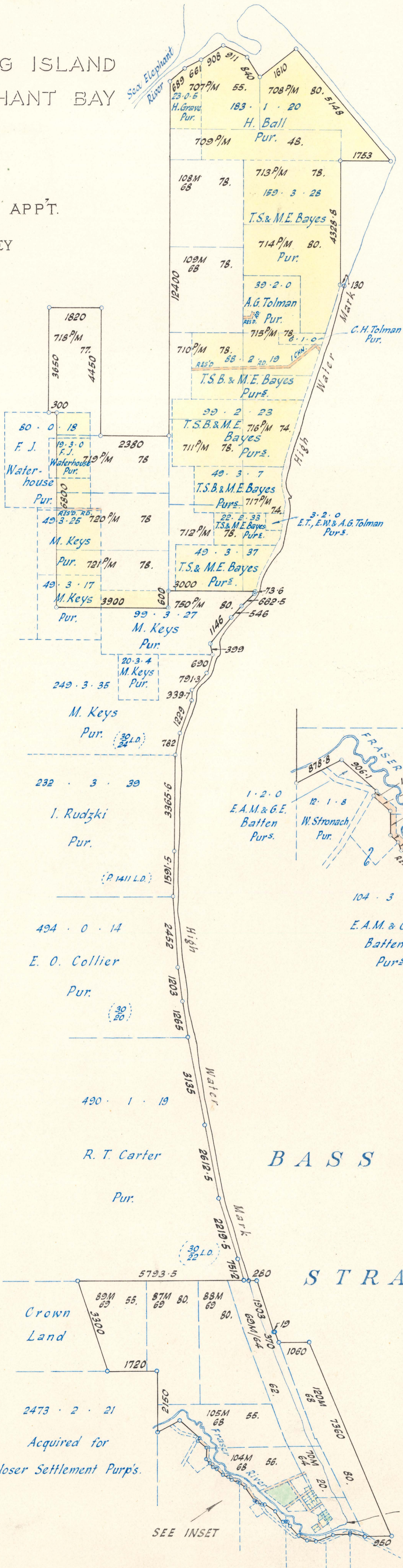

BASS
STRAIT

SCALE : 1 INCH TO 20 CHAINS

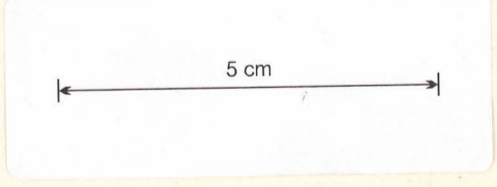

Plotted by: G.A.T. 25-1-74
Entered on General Plan by: G.A.T.
Finally Examined by: A.B. 13-2-74

Acquired for
Closer Settlement Purp's.

SEE INSET

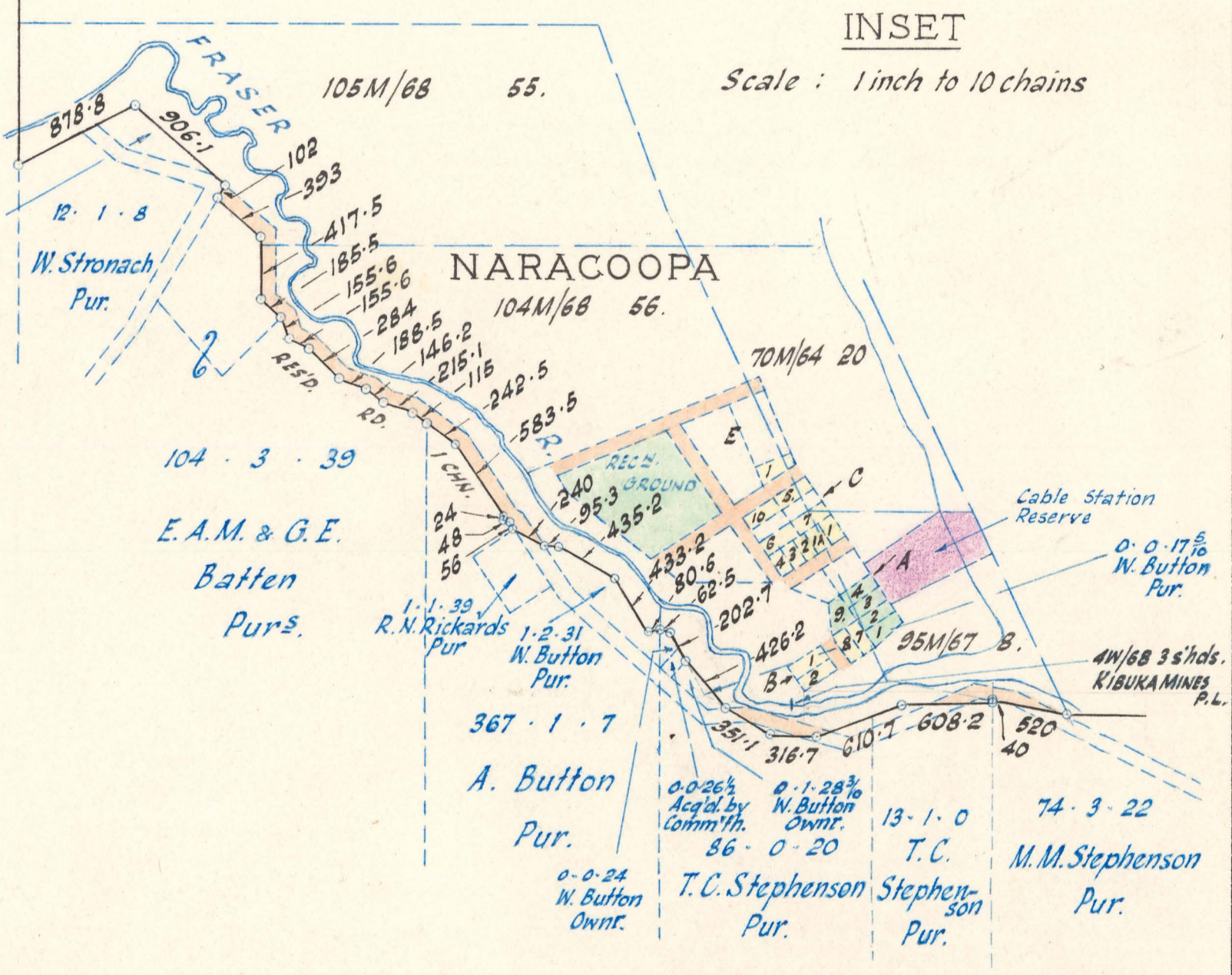

INSET
Scale : 1 inch to 10 chains

- Section A. Lot 1. 0-1-10 Acq'd. by Commwith.
- 2. 0-1-0 " " "
- 3. 0-1-0 " " "
- 4. 0-1-0 " " "
- 7. 0-0-30% W. Button Pur.
- 8. 0-1-0 E.M. Milsom Pur.
- 9. 0-1-8 Reserve
- Section B. Lot 1. 0-1-0 W. Button Pur.
- 2. 0-1-0 W. Button Pur.
- Section C. Lot 1. 0-0-32 A.L. Walthe Pur.
- 1A. 0-0-32 W. Button Pur.
- 2. 0-0-32 L.C. Morrison Pur.
- 3. 0-0-32 G.H. Bishop Pur.
- 4. 0-0-32 D.M. Stansfield Pur.
- 5. 0-1-0 G.J. Helyar Pur.
- 6. 0-1-0 M.B. Frazer Pur.
- 7. 0-1-0 M.B. Frazer Pur.
- 10. 0-1-0 G.J. Helyar Pur.
- Section E. Lot 1. 0-1-5 G.J. Helyar Pur.
- 5-0-18 Recreation Ground

APPROVED
[Signature]
DIRECTOR OF MINES

26 FEB 1974

May be Acted Upon/ 15-2-74

Acted Upon

DEPARTMENT OF MINES
28 FEB 1974
[Signature]
H. EAST