

# LAND DISTRICT OF WELLINGTON VICINITY OF UPPER CALDER

SCALE : 1 : 4000

REFERENCE PLAN  
WELLINGTON 3A & 3B.  
F.B. N<sup>o</sup>. 287.

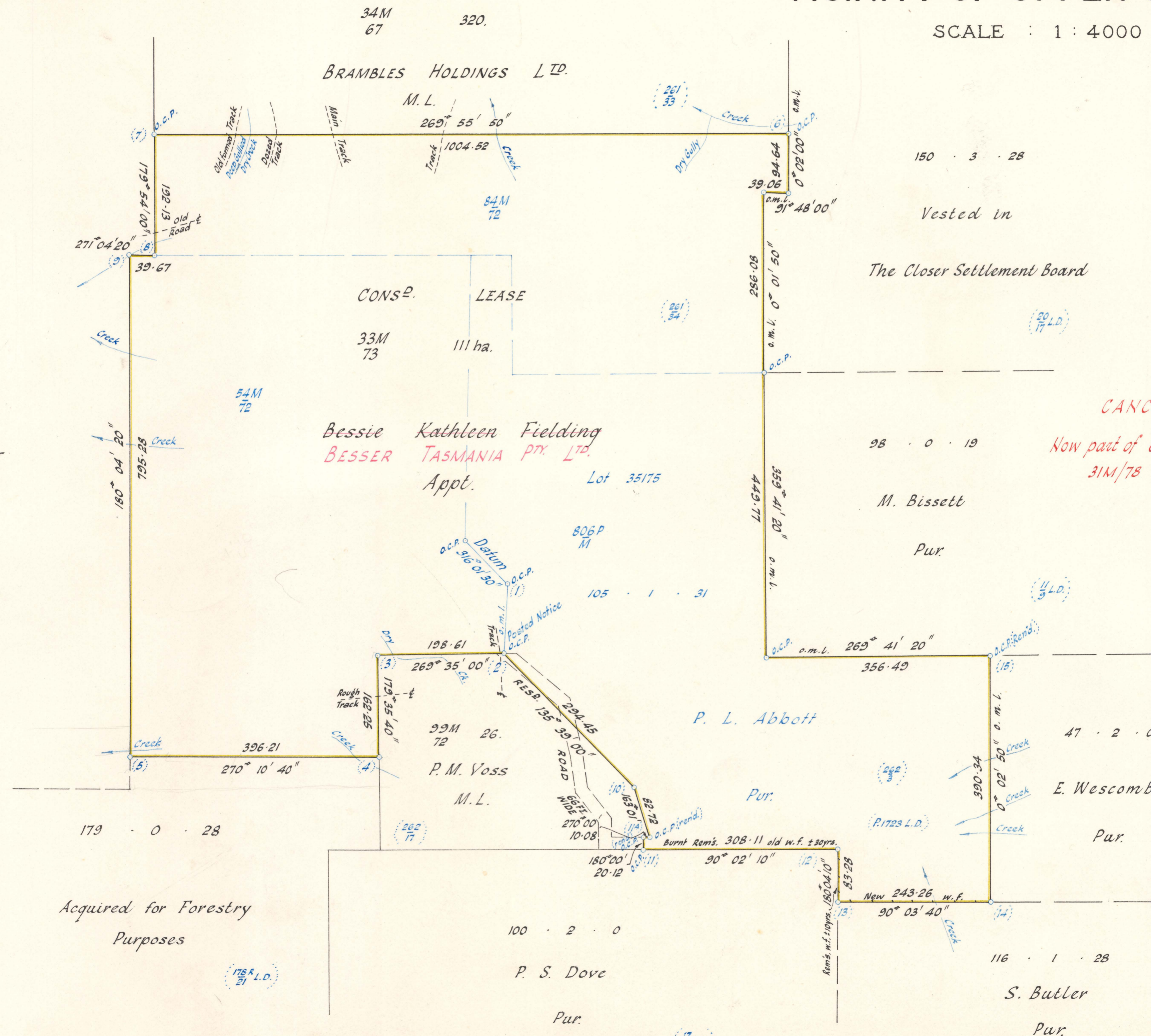

REFERENCE TO CORNERS

COR.	BEARING	DIST. IN METRES	FROM
2	287° 11'	13.48	Peppit
4	90° 16'	23.79	Sty. Bk.
5	322° 16'	4.06	
7	343° 48'	6.90	Sty. Bk.
8	238° 55' 30"	6.04	O. Ref.
9	359° 25' 40"	19.18	Spike Ref.
11	270° 00' 30"	17.22	O.R.M. Bottle
12	118° 34'	0.50	I. Spike
13	90° 03' 40"	0.64	O. Star
14	90° 03' 40"	0.60	O. Star

**CANCELLED**  
Now part of Cons'd. Lease  
31M/78 310 ha.

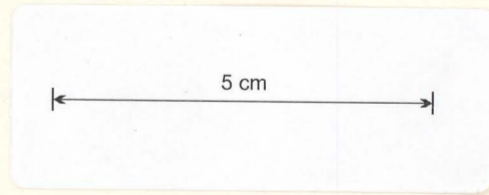

**APPROVED**

- 8 MAY 1974

May be Acted Upon 8.5.1974  
Acted Upon

Authorised Surveyor

Date of Instruction 30.8.73.  
 Survey Commenced 11.10.73.  
 Survey Finished 11.12.73.  
 Error of Close 1 : 3800  
 Plotted by 4/12.4.74.  
 Entered on General Plan 4/6.5.74.  
 Finally Examined 7.5.74.

Acquired for Forestry  
Purposes

