

- = CONNORVILLE STATION PTY LTD
9073 acres - see APPOINTMENT OF NEW TRUSTEE - 39/8140.
- = CONNORVILLE ESTATES PTY LTD
CONVEYANCE NO. 16/3916 = 27470 acres LESS 15.87 ha conveyed to Connorsville Estates by No. 45/2666.
- = CONNORVILLE ESTATES P/L
961 acres of C/T CXXXIX/189
1686 acres
- = CONNORVILLE ESTATES P/L
1971-1991 C/T 6/2/20
- = CONNORVILLE ESTATES PTY LTD
P/GAANT - CC11/71 = 3891 & 1434 P.

CONNORVILLE ESTATES P/L
14/1/1928
447/46
17/2/24/16
3/2/24/16
- CONNELLS PTY LTD
3661 & 3431 P
199 & 34 15 P - C/T 2287/51
977 & 180 P - C/T 2346/19
- RAO CONNOR TRUST
LITTLE RUN 1,2000 ACRES

RENEWED UNTIL 6th APRIL 1983.

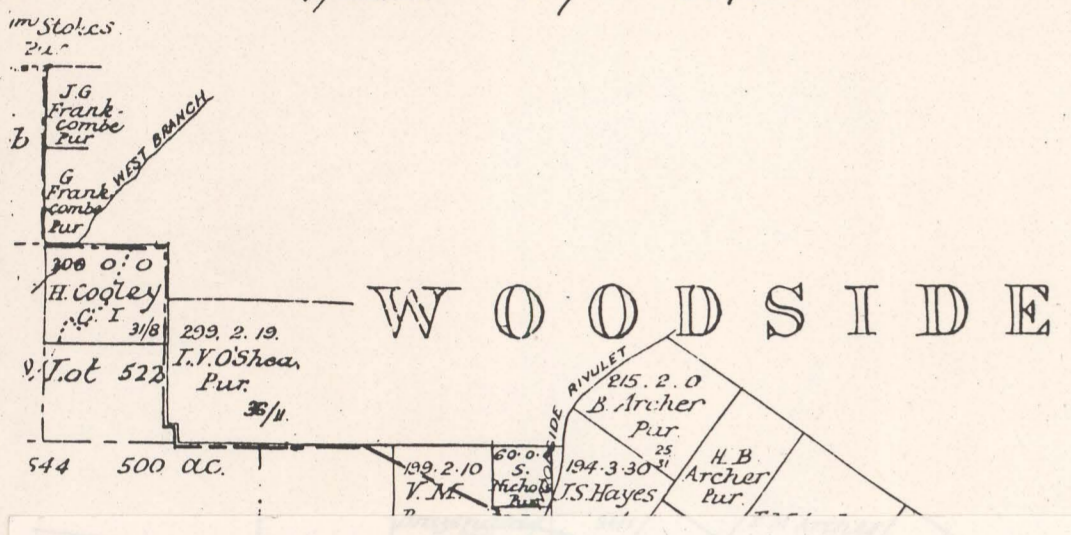

DOUGLAS & COLLINS
BARRISTERS & SOLICITORS

JOHN LORD, LL.B.
ANTHONY FRANCIS CURVEN MATSON, LL.B.
JOHN THEODORE SCOTT, LL.B.
EWAN CHARLES CRAWFORD, LL.B.
RANDALL LUDLOW AREKLAND, LL.B.

YOUR REF. 423/2
IN REPLY PLEASE QUOTE OUR REF. MKP:JTS

TELEPHONE 31 5988 (7 LINES)
P.O. Box 994
DX 70102 LAUNCESTON
HAVELOCK CHAMBERS
9-13 GEORGE STREET, LAUNCESTON, TASMANIA. 7250

3 June 1982

The Director of Mines
Department of Mines
G P O Box 124 B
HOBART 7001

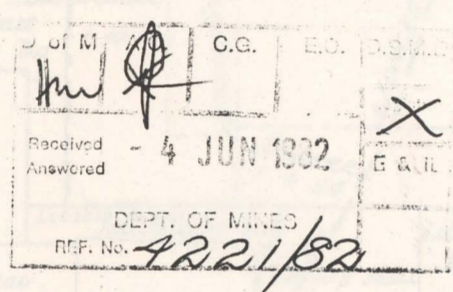

Dear Sir

RE MINING ACT, 1929, AND REGULATIONS
RE CONNORVILLE STATION PTY LTD;
CONNORVILLE ESTATES PTY LTD
CONNELLS PTY LTD

In reply to your letter of the 31st ult. we enclose herewith an up to date map including title references, as we presume this will be of more help than copies of separate titles.

Yours faithfully
DOUGLAS & COLLINS

Per M K PAGE

enclosure

