

UPPER NATONE FOREST RESERVE

LAND DISTRICT OF DEVON
PARISH OF KARA

SCALE 1 : 1500

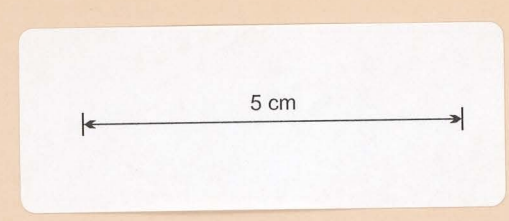

Lot 22278

60.87 ha

J. H. Mc Hugh

Pur.

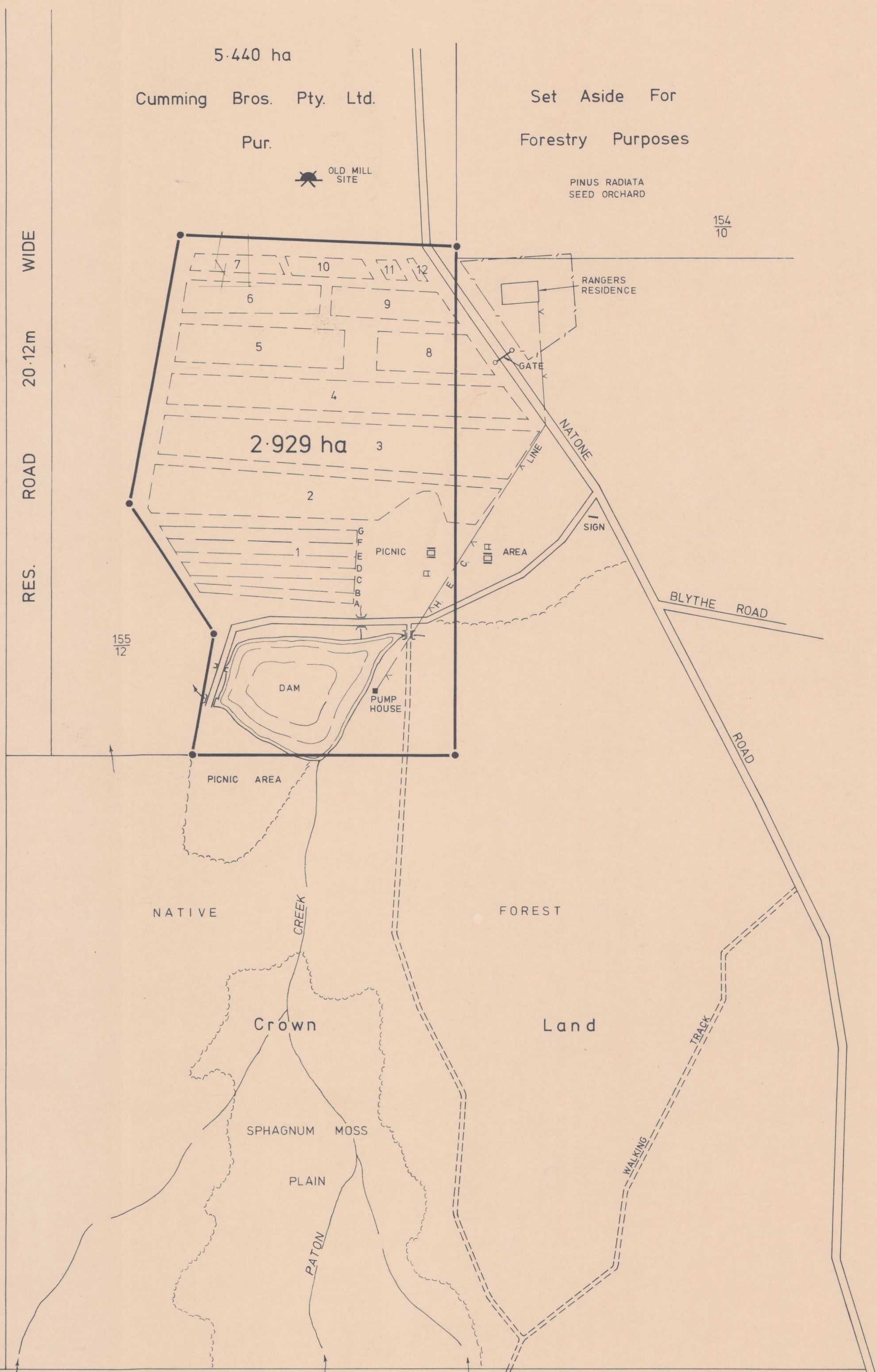

KEY

1	Eucalyptus planted 1974
A)	Eucalyptus globulus
B)	Eucalyptus dalrympleana
C)	Eucalyptus maidenii
D)	Eucalyptus viminalis
E)	Eucalyptus st johnii
F)	Eucalyptus ovata
G)	Eucalyptus smithii
Arboretum planted 1945	
2	Pinus strobus
3	Pinus ponderosa
4	Picea mariana
5	Picea pungens glauca
6	Chamaecyparis lawsoniana
7	Pinus thunbergii
8	Pinus laricio
9	Cedrus deodara
10	Thuja plicata
11	Sequoia gigantea
12	Cryptomeria japonica

☐ PICNIC TABLE
▤ BARBEQUE

F.L. PENDING SHELL CO

UPPER NATONE FOREST RESERVE

LAND DISTRICT OF DEVON
PARISH OF KARA

SCALE 1:1500



KEY

1	Boundary of the Reserve
2	Boundary of the Parish
3	Boundary of the Land District
4	Boundary of the County
5	Boundary of the Province
6	Boundary of the State
7	Boundary of the Territory
8	Boundary of the Dominion
9	Boundary of the Empire
10	Boundary of the Commonwealth
11	Boundary of the United Nations
12	Boundary of the World