

5 cm

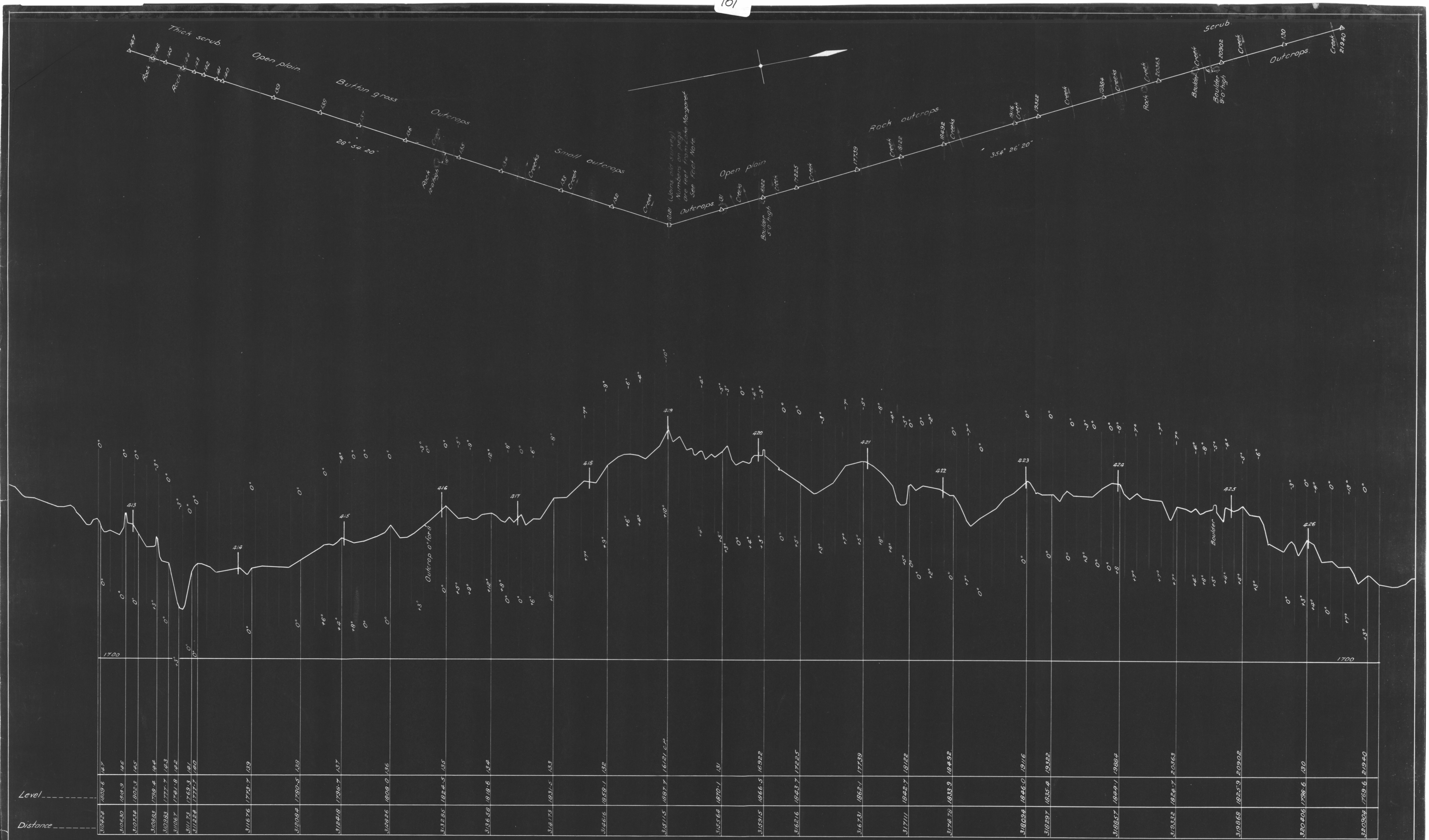

Subtract 140' from distance for Nive datum

NOTE  
 Peg numbers on old survey are as deciphered, but are not reliable.  
 From Station '6' (sheet '27) actual distances are 45ft shorter than shown.  
 From Point 'D' (sheet '23) levels are 14ft lower than shown.

*Maclean*  
 COMMISSIONER  
 11.1.35

GOVERNMENT OF TASMANIA  
 HYDRO-ELECTRIC DEPT.  
 NIVE-ROSEBERY TRANSMISSION LINE  
 PLAN AND LONGITUDINAL SECTION

SCALE	Horizontal 1" = 400'	Vertical 1" = 50'
DRAWN	G.S.D.	
CHECKED	G.S.D.	
APPROVED	G.S.D.	
DATE	10/1/35	

DRAWING REFERENCE  
 Level Books 216 & 217

SHEET "31  
**4490**  
 38 SHEETS