

5 cm

103

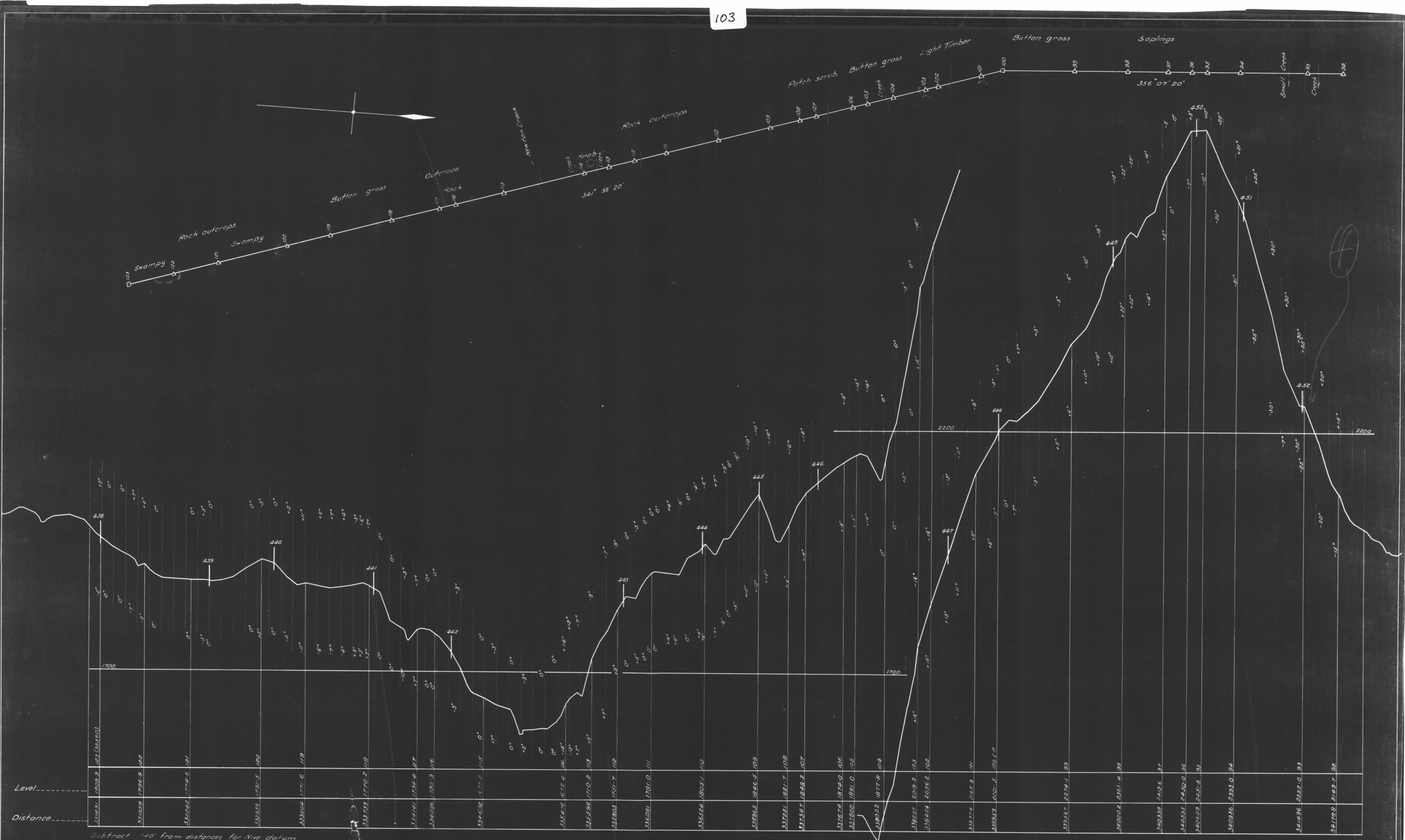

Subtract 140' from distances for Nive datum

**NOTE**  
 From Station 6 (sheet #21) actual distances are 250ft shorter than shown.  
 From Point D (sheet #23) levels are 10ft lower than shown.

*M. H. H. H.*  
 COMMISSIONER  
 11-1-34

GOVERNMENT OF TASMANIA  
 HYDRO-ELECTRIC DEPT.  
**NIVE-ROSEBERY TRANSMISSION LINE**  
 PLAN AND LONGITUDINAL SECTION

Horizontal 1" = 400'  
 Vertical 1" = 40'

Level Book # 216  
 10/1/35

**4492**  
 38 SHEETS

SHEET # 33