

106

5 cm

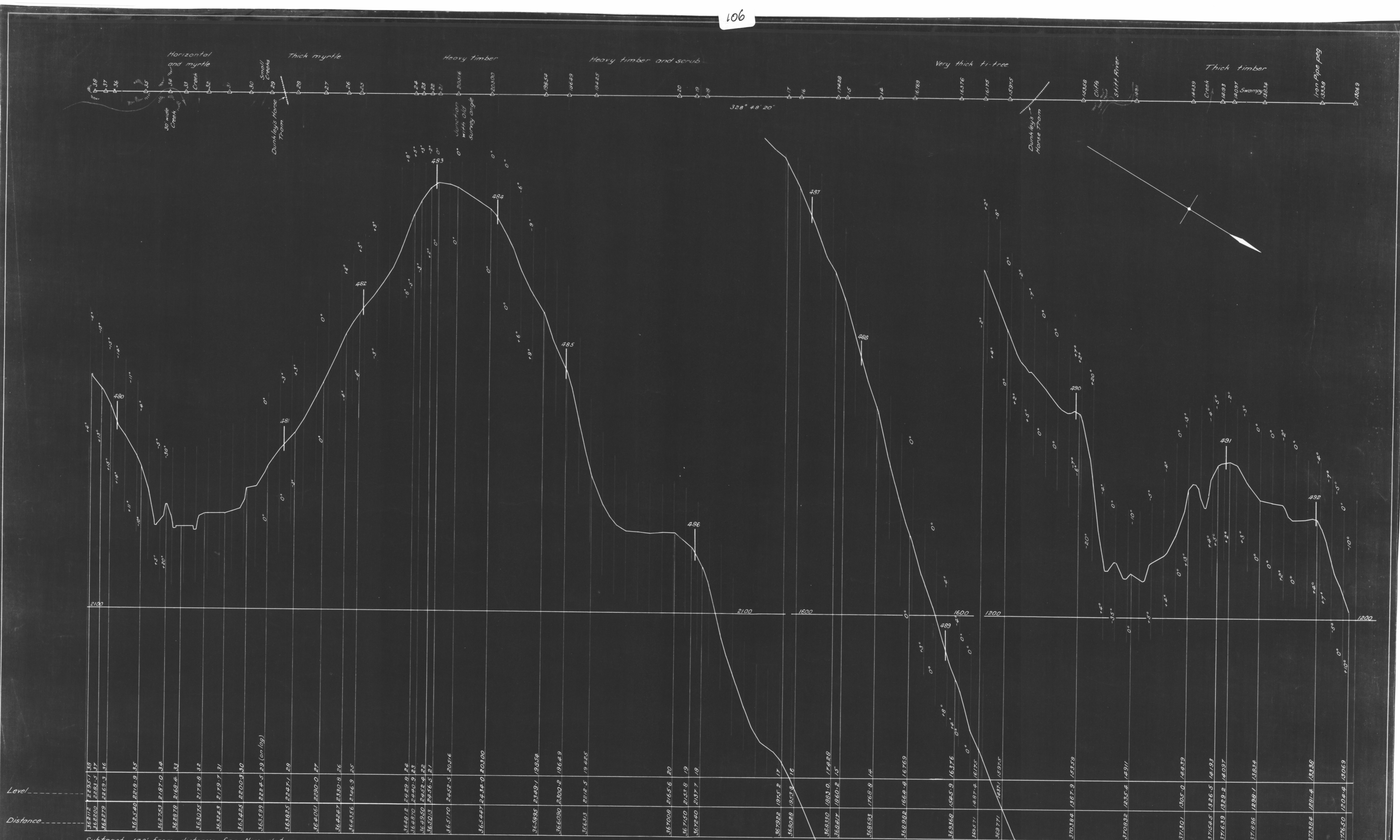

Subtract 140' from distances for Nive datum.
 Peg numbers on old survey as deciphered, but not reliable

NOTE

From Station 6 (sheet #2) actual distances are 450 ft shorter than shown.
 From Point D (sheet #23) levels are 19 ft lower than shown.

Fred H. Field
 COMMISSIONER
 12/10/34

GOVERNMENT OF TASMANIA
 HYDRO-ELECTRIC DEPT.
 NIVE-ROSEBERY TRANSMISSION LINE
 PLAN AND LONGITUDINAL SECTION

SCALE	Horizontal: 1" = 400'
	Vertical: 1" = 20'
DRAWN	<i>F.H.F.</i>
CHECKED	<i>R.H.F.</i>
APPROVED	<i>F.H.F.</i>
DATE	12/10/34

SHEET # 36

4495

38 SHEETS