

DEMOLITION NOTE
Buildings noted below A, B & C, shall be removed by others to foundation level. Contractor will be responsible for breaking up & removing existing foundations, for a distance of 12" below natural ground level.

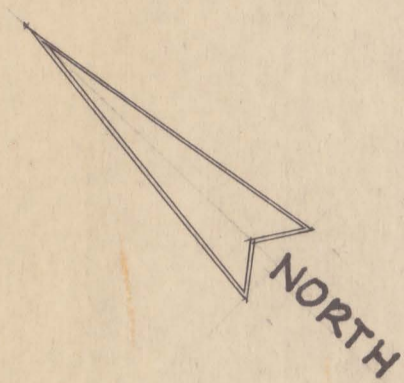

remove exist. ornamental fence, gates etc.

GALVIN STREET.

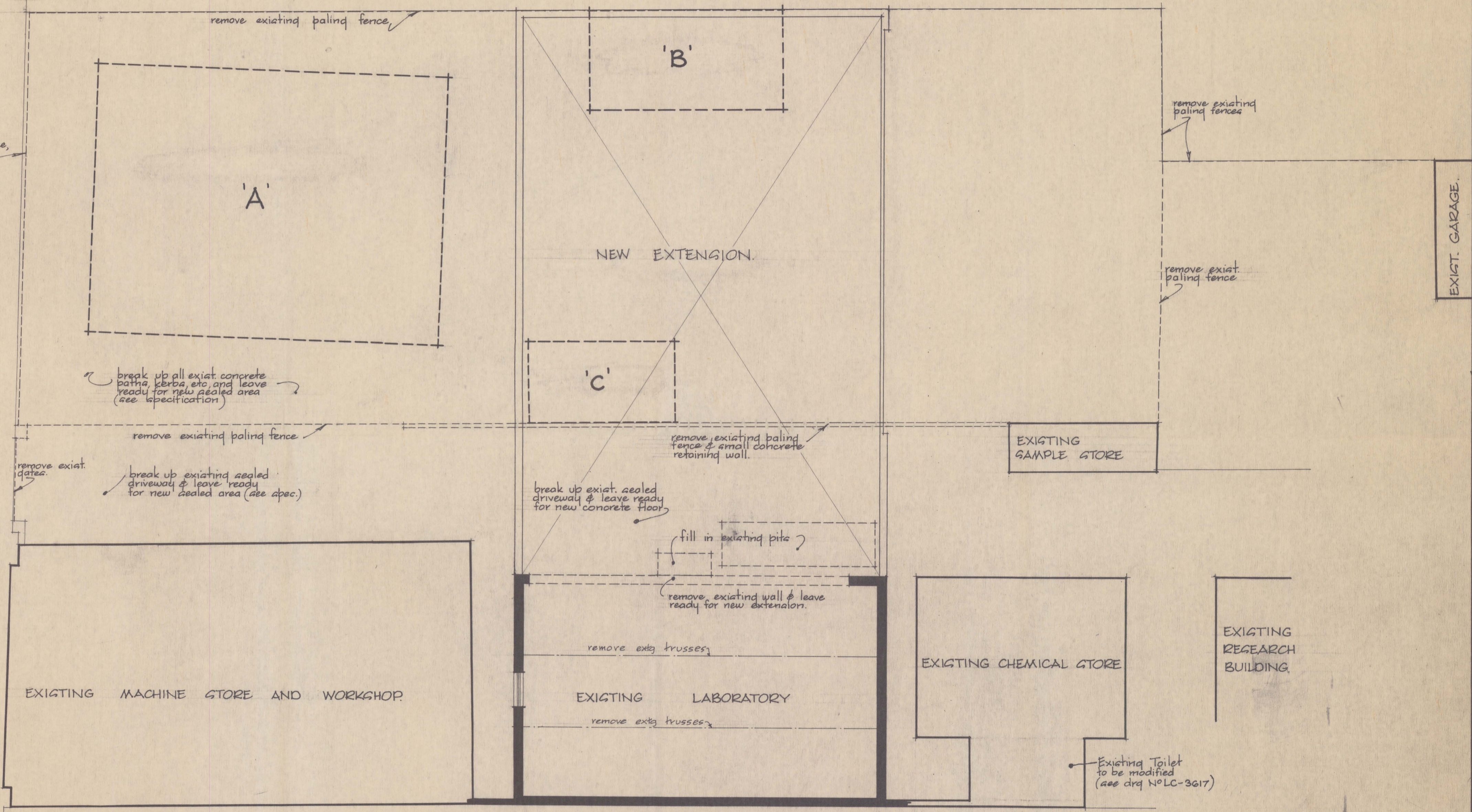

EXISTING MACHINE STORE AND WORKSHOP

EXISTING LABORATORY

EXISTING CHEMICAL STORE

EXISTING SAMPLE STORE

EXISTING RESEARCH BUILDING

EXIST. GARAGE.

remove existing paling fence

break up all exist. concrete paths, kerbs, etc. and leave ready for new sealed area (see specification)

remove exist. gates.

break up existing sealed driveway & leave ready for new sealed area (see spec.)

remove existing paling fence

remove existing paling fence & small concrete retaining wall.

break up exist. sealed driveway & leave ready for new concrete floor

fill in existing pits

remove existing wall & leave ready for new extension.

remove extg trusses

remove extg trusses

Existing Toilet to be modified (see drg N° LC-3617)

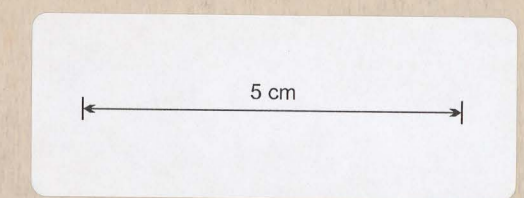

DEPARTMENT OF PUBLIC WORKS - TASMANIA		
MINES DEPARTMENT - LAUNCESTON - LABORATORY EXTENSIONS		
SCALE - 8'0" = 1"	DRAWN - G.C.H.	WORKING DRAWING DEMOLITION
<i>Geo. W. ...</i> DISTRICT ARCHITECT	TRACED -	
C. D. ROSE, CHIEF ARCHITECT	DATE - 14-12-02.	DRAWING No. - LC-3616