

815

273

5 cm

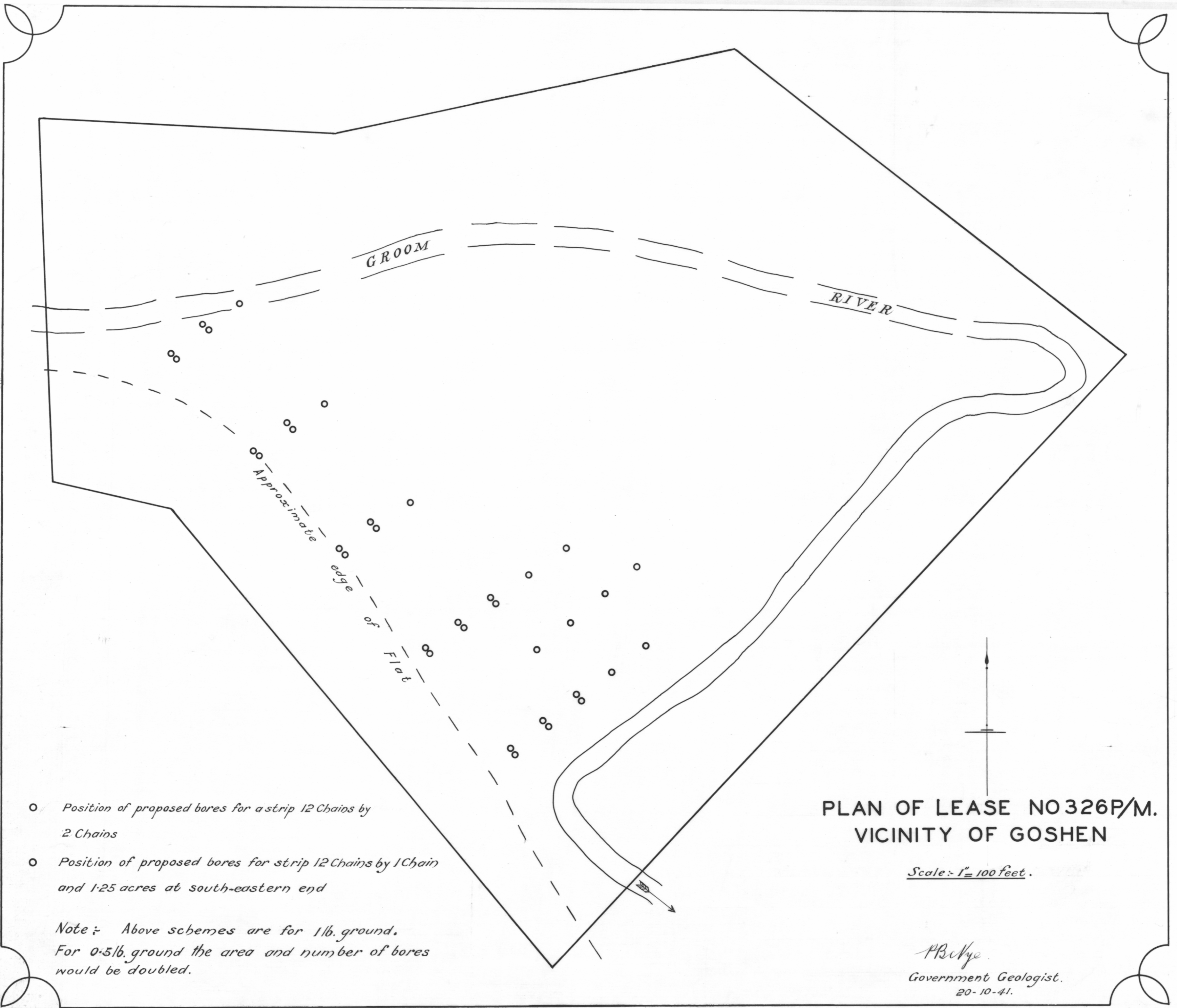

- Position of proposed bores for a strip 12 Chains by 2 Chains
- Position of proposed bores for strip 12 Chains by 1 Chain and 1.25 acres at south-eastern end

Note: Above schemes are for 1lb. ground.
 For 0.5lb. ground the area and number of bores would be doubled.

PLAN OF LEASE NO 326P/M.
 VICINITY OF GOSHEN

Scale: 1" = 100 feet.

P. B. Nye
 Government Geologist.
 20-10-41.

815/41

9-815