

# PLAN OF ANCHOR MINE

SCALE :- 100 FEET TO AN INCH

LEGEND	
Tin Granite	
Porphyritic Granite	

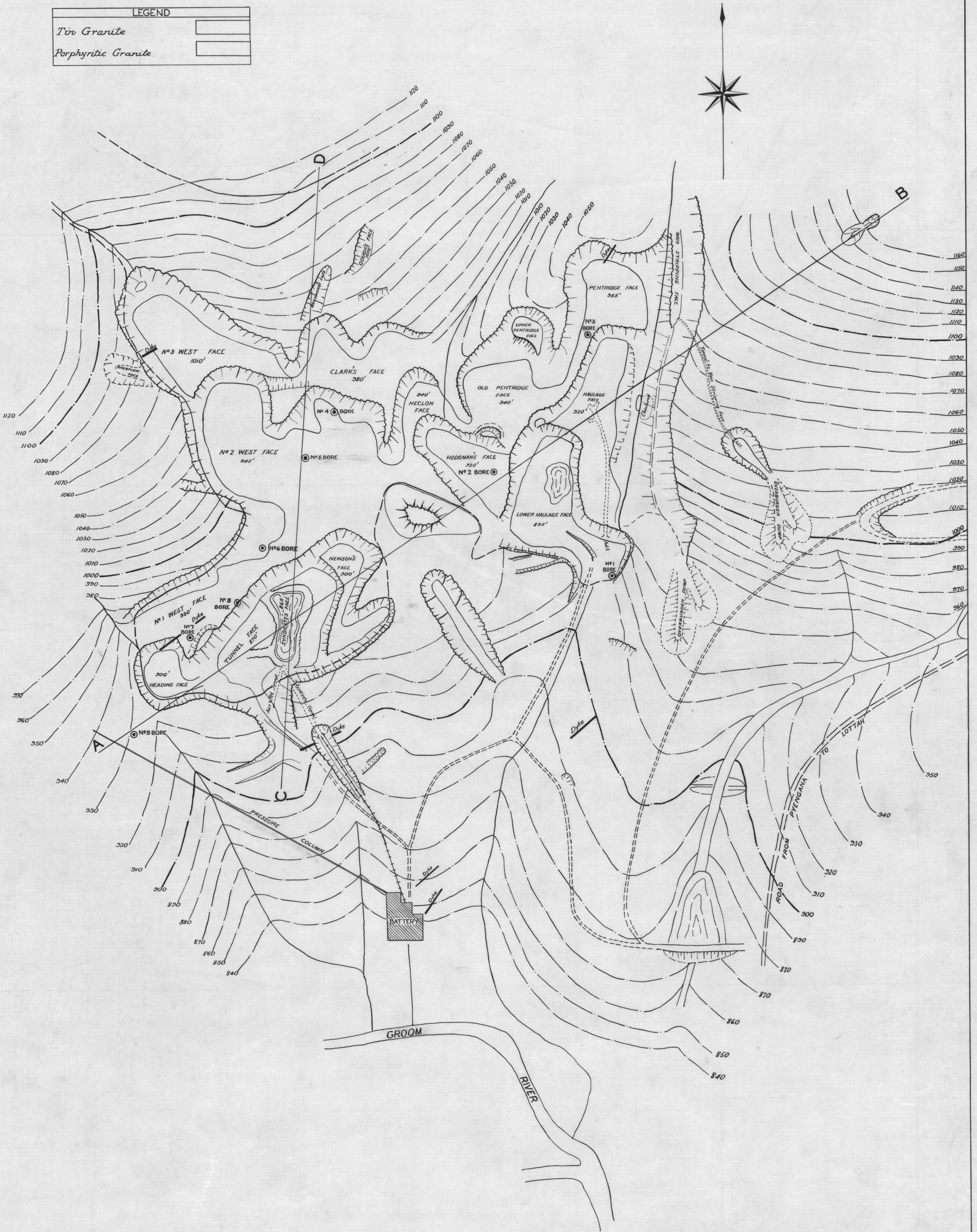

## SECTIONS

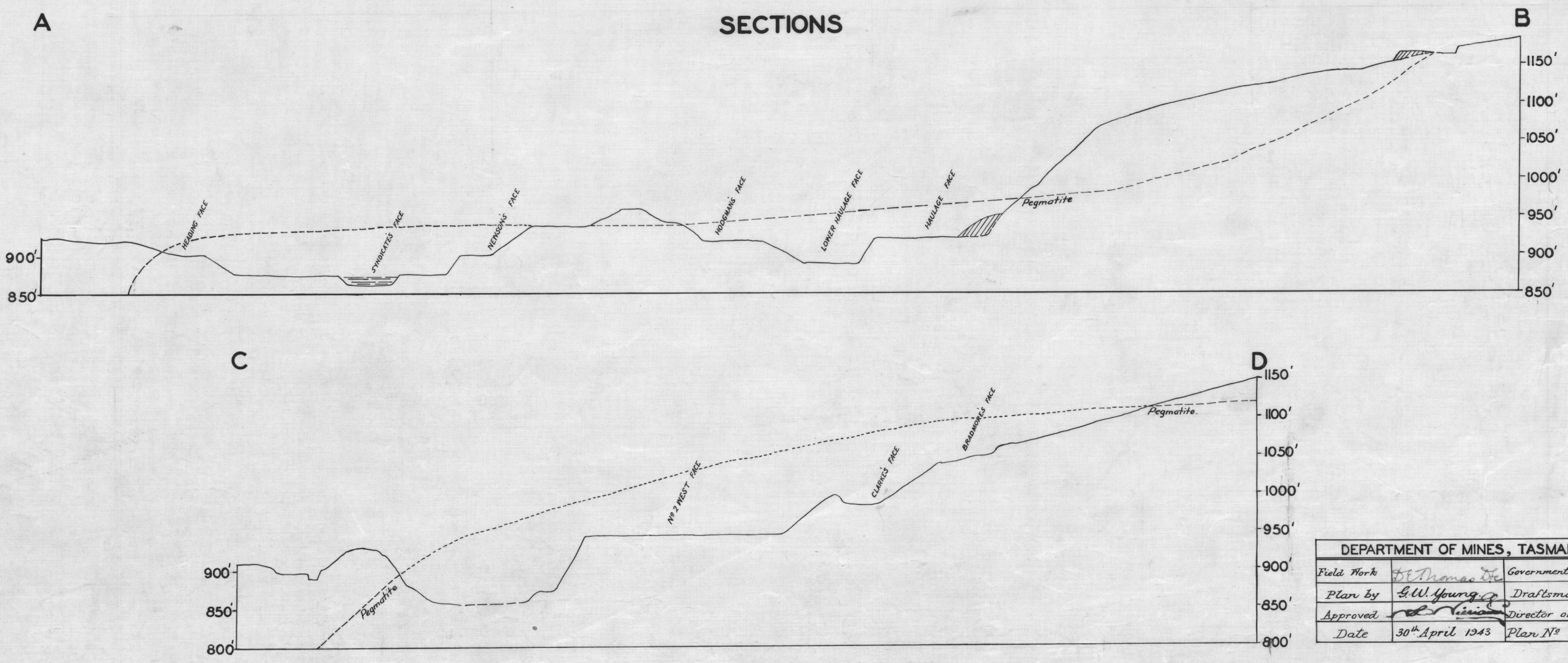

DEPARTMENT OF MINES, TASMANIA		
Field Work	<i>H. J. Moran</i>	Government Geologist
Plan by	<i>G. W. Young</i>	Draftsman
Approved	<i>G. W. Young</i>	Director of Mines
Date	30 <sup>th</sup> April 1943	Plan No 840.