

860 B A

352

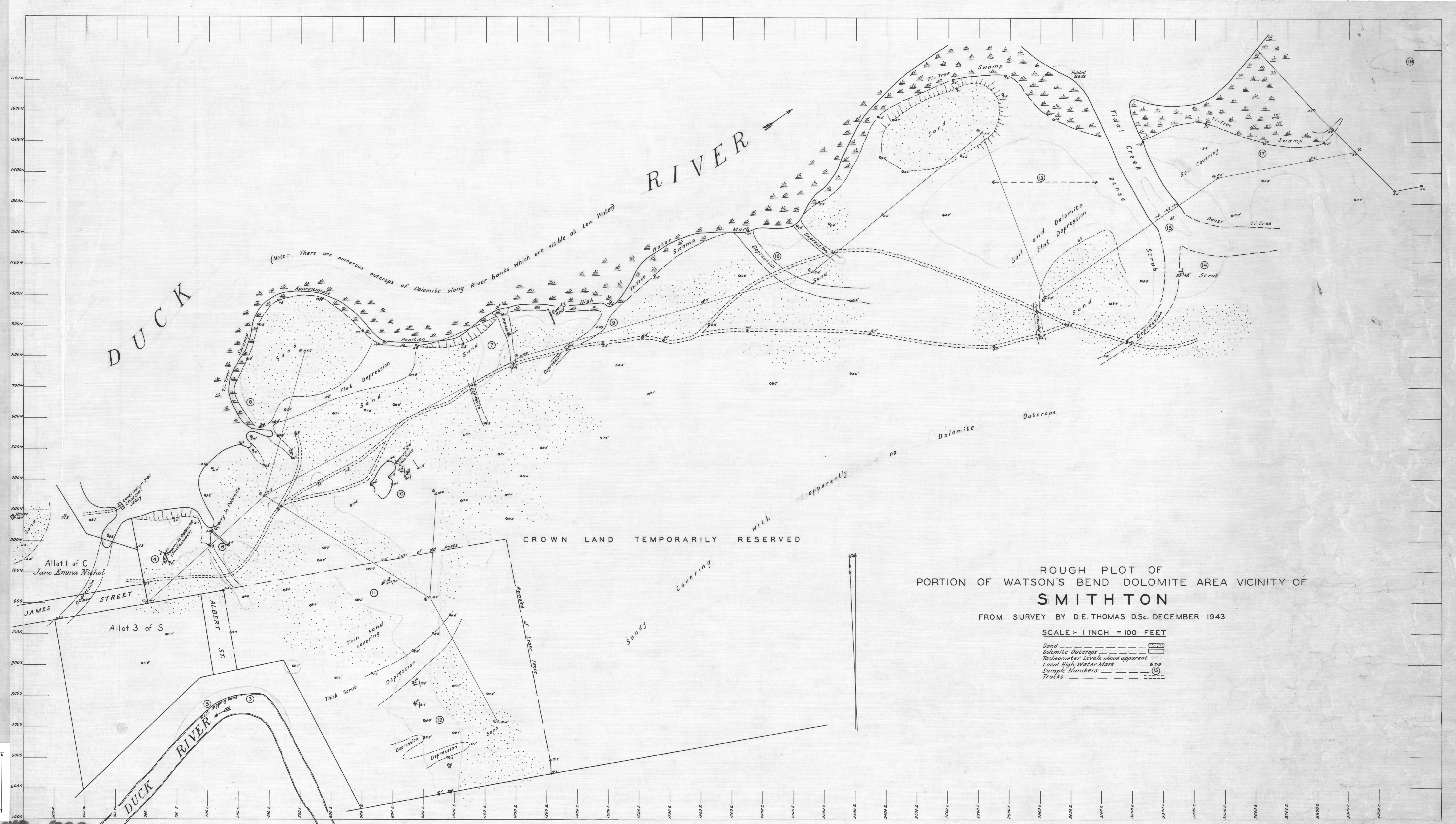

ROUGH PLOT OF
 PORTION OF WATSON'S BEND DOLOMITE AREA VICINITY OF
SMITHTON
 FROM SURVEY BY D.E. THOMAS D.Sc. DECEMBER 1943

SCALE - 1 INCH = 100 FEET

- Sand
- Dolomite Outcrops
- Tacheometer Levels above apparent
- Local High Water Mark
- Sample Numbers
- Tracks

2/560