

HOLE NO. BT 176

GOLD FIELDS EXPLORATION PTY. LIMITED
DIAMOND DRILL HOLE PLOT

SCALE 1:

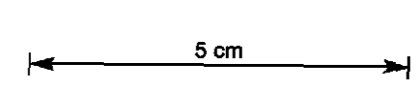

PLAN

⊕ 5435 924 N
584 884 E

396.1 m R.L. —————

374.0 m R.L. —————

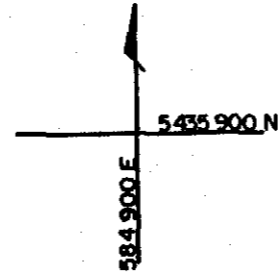

0.01 % Sn

DIP PROFILE

316.0 m R.L. —————

657257

GOLD FIELDS EXPLORATION PTY. LIMITED
DRILL CORE LOG AND ASSAY DATA

PROJECT: BLUE TIER

HOLE NUMBER: B.T. 176

Page: 1.

ULV. PRESS

INTERVAL		RECOVERY		DESCRIPTION	ASSAY DATA (ppm)													
From	To	m	%		Sample No.	From	To	Rec. %	Sn									
				SUMMARISED LOG														
0.0	21.5	14.0		MODERATELY ALTERED, MEDIUM GRAINED, PORPHYRITIC POIMENA ADAMELLITE.														
21.5				CONTACT														
21.5	80.0	58.5		WEAKLY ALTERED TO UNALTERED ALKALI GRANITE. MEDIUM GRAINED AND EQUIGRANULAR.														
				DETAILED LOG														
				0.0-21.5 MODERATELY ALTERED, MEDIUM GRAINED POIMENA ADAMELLITE.														
0.0	9.0	9.0		Tricone, no core recovered.														
9.0	19.5	3.0	30	Moderately weathered and altered, brown-grey-pink granite.														
	(9.0-20.0, 3.5m recovered)			Medium grained and weakly porphyritic with patches of hematitic feldspar developed. Limonite is common at the top of the unit. Moderately to highly fractured in places with some crushed zones.														
19.5	21.5	2.0	100	Pale pink-grey aplite. Very fine grained and weakly altered. Weakly fractured, with sericite (yellow) infillings. Slightly hematitic in places. Unusual, subhorizontal quartz lamellae approx. 2mm thick are developed throughout.	6201	21.5	22.5	100	20									
				At 21.2, a 30cm pegmatite-aplite occurs. It consists of quartz feldspar and unaltered biotite.	6202	22.5	23.5	100	50									
					6203	23.5	24.5	100	40									
					6204	24.5	25.5	100	20									
21.5				CONTACT	6205	25.5	26.5	100	20									
					6206	26.5	27.5	100	20									
				21.5-80.0 WEAKLY ALTERED TO UNALTERED ALKALI GRANITE.	6207	27.5	28.5	100	20									
					6208	28.5	29.5	100	30									
21.5	80.0	58.5	100	Weakly altered alkali granite. Medium grained and equigranular. A few patches (up to 0.5m thick) of stronger, moderately altered granite occur. These are dark green, otherwise the rock is very	6209	29.5	30.5	100	30									
					6210	30.5	31.5	100	30									
					6211	31.5	32.5	100	20									

657258

GOLD FIELDS EXPLORATION PTY. LIMITED
DRILL CORE LOG AND ASSAY DATA

PROJECT: BLUE TIER

HOLE NUMBER: B.T. 176

Page: 2.

ULV. PRESS

INTERVAL		RECOVERY		DESCRIPTION	ASSAY DATA (ppm)															
From	To	m	%		Sample No.	From	To	Rec. %	Sn											
				pale green-cream in colour. Weakly fractured, with the occasional sericite filled fracture.	6212	32.5	33.5	100	30											
					6213	33.5	34.5	100	40											
				Below 53.0, the 'greeness' and degree of alteration decreased to give pale cream unaltered alkali granite. This is a uniform alteration state.	6214	34.5	35.5	100	40											
					6215	35.5	36.5	100	30											
					6216	36.5	37.5	100	40											
					6217	37.5	38.5	100	40											
					6218	38.5	39.5	100	40											
				END OF HOLE 80.0	6219	39.5	40.5	100	40											
					6220	40.5	41.5	100	40											
					6221	41.5	42.5	100	30											
					6222	42.5	43.5	100	20											
					6223	43.5	44.5	100	20											
					6224	44.5	45.5	100	10											
					6225	45.5	46.5	100	30											
					6226	46.5	47.5	100	20											
					6227	47.5	48.5	100	10											
					6228	48.5	49.5	100	20											
					6229	49.5	50.5	100	20											
					6230	50.5	51.5	100	10											
					6231	51.5	52.5	100	20											
					6232	52.5	53.5	100	10											

657259