

**RENISON LIMITED - DRILL CORE RECORD BT 109**

HOLE NUMBER	BT109	SURVEY			From - To	Distance D	VERTICAL		HORIZONTAL	
		Depth	Bearing	Dip			D.Sin.Dip	R.L.	D.Cos.Dip	Prog.Total
PURPOSE	To test for extensions to Anchor mineralisation.	0	GRID	- 90	0 - 25.5	25.5	25.5		0	0
		51	242	- 89.75	- 75.5	50.0	50.0		0.2	0.2
LOCATION	South east of Anchor open out	100	273	- 88.75	-101.0	25.5	25.49		0.56	0.76
COLIAR R.L.	282.2									
COORDINATES	5222.49N 5056.9E									
LENGTH	101m									
HOLE SIZE	0 - 12m Tricone - 21m NQ - 101m BQ									
DATE DRILLED	30.1.81 to 2.2.81									
SIGNIFICANT CORE LOSS ZONES										
ORE ZONE GROUND CONDITIONS										
LOGGED BY	A. ROSS									
COMMENTS	Low grade tin mineralisation encountered in a pegmatitic variety of the alkali granite, and well below the contact with Poimena Adamellite.									

**SUMMARY - ASSAY DATA**

LODE NAME	FROM	TO	LENGTH (m)	AVERAGE WEIGHTED ASSAYS											B.C.A.
				Sn.	Acid Sol. Sn.	Cu.	As.	S.	Pb.	Zn.	Bi.	WO <sub>3</sub>	Ag g/t		
0.1% Cut off	75(207.2RL)	87(195.2RL)	12	0.16		<0.05					<0.01			6	

HOLE No BT 109

SCALE:

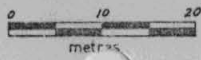

RENISON LIMITED  
DIAMOND DRILL HOLE PLOT

BT 109

5 cm

PLAN

⊕ 5222-5N.  
5056-9E.

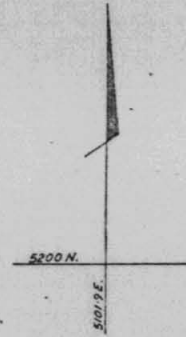

DIP PROFILE

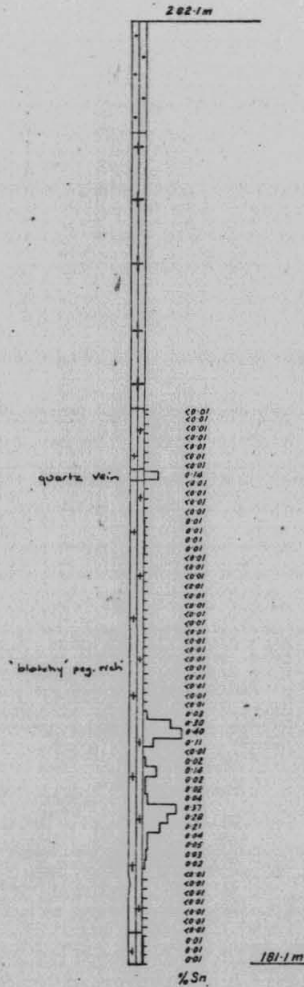

892095

## DIAMOND DRILL RECORD

HOLE NUMBER : BT109

LOGGED BY : AFR

RWPS

INTERVAL (m)		RECOVERY		DESCRIPTION	FORM.	% Sn.										
FROM	TO	m	%			FROM	TO	TOTAL	ACID SOL.	% Cu.	% As.	% S.	% Pb.	% Zn.	% Bi.	g/t Ag
				SUMMARISED LOG												
0	12			NON CORING.												
12.0	41.4			COARSE GRAINED ADAMELLITE, MINOR MICROGRANITE, APLITE, PEGMATITE, WEAKLY ALTERED GRANITE (ALKALI) AND WEAKLY PORPHYRITIC MICROGRANITE.												
41.4	49.1			DISCORDANT PEGMATITE - QUARTZ, BORNITE DOMINANT. FAULT FISSURE?												
49.1	97.6			COMPLEX PEGMATITIC VARIANTS OF ALKALI GRANITE. MINOR ZONES OF UNUSUAL ALTERATION (PINKENING, BLOTCHY MICA SEGREGATION). ZONES OF MINERALISED PEGMATITE/GRANITE WITH DISSEMINATED SULPHIDES. MINOR CASSITERITE MINERALISATION.												
97.6	101.0			ALKALI GRANITE -- WEAK GREISEN OF REGULAR APPEARANCE.												
				DETAILED LOG												
0	12.0	0	0	Tricone. No core.												
12.0	17.0	3.3	66.0	Weathered to slightly fresh porphyritic adamellite. Broken fragments of PA and very minor light microgranite.												
17.0	21.5	4.5	100	More competent, slightly weathered PA.												
21.5	24.6	3.1	100	Fresher porphyritic adamellite. Few zones of grey microgranite at 70° CA.												
24.6	25.1	0.5	100	Very broken zone of limonitic weathered PA.												
25.1	26.1	1.0	100	Less weathered slight pink, broken PA. Fragments of grey microgranite at 70° CA.												
26.1	28.9	2.8	100	Grades to grey PA. Moderately broken.												
28.9	30.6	1.7	100	Pinker PA. Some broken core. Rare grey microgranite zone.												
30.6	31.2	0.6	100	Zone of layered to poorly layered aplite, microgranite with narrow pegmatitic zones within. Layering 50-70° CA. Intense pinkening in part. Sharp contacts.												
31.2	31.4	0.2	100	Pinked PA.												

892096

## DIAMOND DRILL RECORD

HOLE NUMBER : BT109

LOGGED BY : AFR

NWPS

INTERVAL (m)		RECOVERY		DESCRIPTION	FORM.	% Sn.										
FROM	TO	m	%			FROM	TO	TOTAL	ACID SOL.	% Cu.	% As.	% S.	% Pb.	% Zn.	% Bi.	g/t Ag
31.4	37.7	6.3	100	Grades to grey fresh PA.												
37.7	38.9	1.2	100	Increasing pinkening of PA.												
38.9	40.0	1.1	100	Zone of complex grey to grey green layered aplite, microgranite tending to alkali granite. First 25cms is very pegmatitic and with large quartz crystals.												
40.0	40.2	0.2	100	Zone of intense pinked variety of PA.												
40.2	40.35	0.15	100	Grey fine mica rock with preferred "mineral elongation" at 80° CA. Sharpish contacts.												
40.35	41.4	1.05	100	Back into pinked PA.												
	41.4			CONTACT.												
41.4	42.0	0.6	100	Complex zone of cream microgranite - pegmatite. Pinkening of feldspars. No mineralisation.												
42.0	43.0	1.0	100	Grades into equigranular blotchy aplite or microgranite. Small "greisening" patches.												
43.0	43.1	0.10	100	Intense scarlet pinked zone. Layered microgranite/aplite. Layering 90° CA. Scarlet alteration is similar to that encountered in BT107.												
43.1	43.3	0.20	100	Creamy equigranular aplitic microgranite.												
43.3	43.55	0.25	100	Grades, almost sharp though, into biotite segregations with scarlet pinked feldspars.												
43.55	48.0	4.45	100	Grades into zone of alkali granite variant with narrow zones of scarlet pinkening and an almost diffuse blotchy alteration. No significant alteration or mineralisation. Blotchy texture better developed over the last 50cms. This zone has a weak porphyritic appearance - could this be the micro adamellite??												
48.0	49.1	1.1	100	Distinct discordant zone. Consists of mainly massive grey white quartz with large patches of chalcocopyrite, minor bornite. Minor feldspar and curious "pegmatite" lithologies on the contact. Sharp but slightly gradational contacts at 45-50° CA. Possible FAULT FISSURE. Minor fluorite with sulphides. No evidence of greisening or cassiterite.												

892097

## DIAMOND DRILL RECORD

HOLE NUMBER : BT109

LOGGED BY : AFR

NWPS

INTERVAL (m)		RECOVERY		DESCRIPTION	FORM.			% Sn.									
FROM	TO	m	%			FROM	TO	TOTAL	ACID SOL.	% Cu.	% As.	% Mn	% Pb.	% Zn.	% Bi.	g/t Ag	% WO <sub>3</sub>
49.1	50.0	0.9	100	Zone of pinkened sub pegmatitic alkali granite? varieties with diffuse zones at 45° CA of layered sericitised granite, pinkened granite. Grades into:		41.4	42	<0.01	0.0015	0.055	0.004			<1			
							43	"	0.0015	0.04	0.0025			<1			
							44	"	0.0025	0.045	0.007			<1			
							45	"	0.002	0.03	0.007			<1			
50.0	51.4	1.4	100	Cream to pink fine grained granite. Weak to nil alteration. Slight pinkening.			46	"	0.003	0.03	0.006			<1			
							47	"	0.0045	0.025	0.005			<1			
							48	"	0.068	0.025	0.0055			4			
51.4	52.4	1.0	100	Marked gradational increase in pinkening, approaching scarlet. Medium grained granite.			49	0.14	3.0	0.025	0.02			110			
							50	<0.01	0.07	0.045	0.0055			3			
							51	"	0.025	0.025	0.005			<1			
52.4	53.2	0.8	100	Cream medium grained granite with patchy pinkening.			52	"	0.0055	0.025	0.0055			<1			
							53	"	0.004	0.025	0.0055			<1			
53.2	53.4	0.2	100	Zone of layered white aplite and grey alteration. Layering 90° CA. Topaz rich?			54	0.01	0.008	0.03	0.0055			<1			
							55	<0.01	0.008	0.025	0.005			<1			
							56	0.01	0.011	0.025	0.006			1			
53.4	56.8	3.4	100	Pink to cream equigranular alkaline granite with little observed alteration.			57	"	0.014	0.03	0.008			1			
							58	<0.01	0.009	0.03	0.007			1			
							59	"	0.006	0.03	0.007			<1			
56.8	57.0	0.2	100	Zone of lime green, black micas. Vein at 45° CA about a fine white steatite (kaolin?) veinlet.			60	"	0.0085	0.025	0.0085			1			
							61	"	0.0065	0.025	0.007			1			
							62	"	0.01	0.03	0.0085			1			
57.0	63.0	6.0	100	Monotonous but slightly variable zone of equigranular alkali granite with zones of lesser or more scarlet pinkening up to 10cms. Pinkening commonly occurs around joints, often coated with lime green clay.			63	"	0.004	0.025	0.008			<1			
							64	"	0.0035	0.025	0.007			<1			
							65	"	0.0025	0.025	0.0065			<1			
							66	"	0.0035	0.025	0.0045			4			
63.0	63.04	0.04	100	Kaolin breccia vein with coarse quartz and feldspar on the basal contact,			67	"	0.0015	0.025	0.0065			<1			
							68	"	0.002	0.03	0.007			<1			
							69	"	0.001	0.03	0.0055			<1			
63.04	65.1	1.96	100	As before but with gradual coarsening of texture and increased minor kaolin veinlets.			70	"	0.0025	0.025	0.0045			<1			
							71	"	0.01	0.03	0.0065			1			
							72	"	0.005	0.03	0.005			<1			
65.1	70.3	5.2	100	Coarse to medium grained alkali granite with pinkened zones and black biotite. Very minor alteration. Base marked by gradual change to texture and broken zone.			73	"	0.004	0.025	0.005			<1			
							74	"	0.02	0.03	0.0055			2			
							75	0.03	0.46	0.03	0.012			33			
							76	0.30	0.0475	0.035	0.0055			3			
70.3	70.5	0.2	100	Very broken strange textured pegmatitic variety.			77	0.40	0.10	0.035	0.007			10			
							78	0.11	0.21	0.03	0.0065			28			
70.5	76.9	6.4	100	Consists of curious pegmatitic segregations in a mainly pink aplitic rock.			79	<0.01	0.016	0.025	0.0045			2			
							80	0.02	0.006	0.025	0.006			<1			
							81	0.14	0.043	0.025	0.0055			5			
76.9	77.3	0.4	100	Similar rock to above but with dark green grey greisenised appearance. Trace cassiterite and sulphides. Almost a granular greisen.			82	0.02	0.003	0.03	0.005			<1			
							83	"	0.004	0.03	0.005			<1			
							84	0.04	0.0365	0.03	0.0055			5			

892093

