

REXSON LIMITED - DRILL CORE RECORD

226

HOLE NUMBER	FED 7	SURVEY			From - To	Distance D	VERTICAL		HORIZONTAL	
		Depth	Bearing	Dip			D.Sin.Dip	R.L.	D.Cos.Dip	Prog. Total
PURPOSE	To test IP anomaly "M"		Magnetic							
		0m	-	-70°	0-17	17	15.975	355.896	5.814	5.814
		35m	340°	-71°	17-50	33	31.202	324.694	10.745	16.559
LOCATION	~310 W 660N grid	65m	340°	71	50-80	30	28.365	296.329	9.768	26.327
		95m	340°	-71	80-98.2	18.2	17.208	279.121	5.926	32.253
COLLAR R.L.	371.871									
CO-ORDINATES	5359974.758 N 349812.012 E									
LENGTH	98.2m									
HOLE SIZE	0-6.0 BQ 6.0-27.0 BQ 27.0-98.2 BQ									
DATE DRILLED	14.1.80 to 18.1.80									
SIGNIFICANT CORE LOSS ZONES	1.2m at 8.5-11.5m 0.9m at 23.2-26.2m 1.1m at 47.5-49.6m									
ORE ZONE GROUND CONDITIONS										
LOGGED BY	P. Roberts									
COMMENTS	The hole was drilled in the hope that IP anomaly "M" would coincide with a mineralized greisen at the contact between the "red" and "white" granites. Intense hematite/clay alteration intersected from the surface to just below the "red"/"white" contact was therefore unexpected. At least 4 different phases of alteration occurred (earliest first): (1) tourmaline/quartz or greisenization (2) hematite/clay (sericite/pinite)/chlorite (3) tourmaline mica/quartz greisen (only one intersection) (4) late stage limonitic veining A possible 5th type is K-feldspar alteration occurring at a time between (1) and (2).									

SUMMARY - ASSAY DATA

LODE NAME	FROM	TO	LENGTH (m)	AVERAGE WEIGHTED ASSAYS										B.C.A.
				Sn.	Acid Sol. Sn.	Cu.	As.	S.	Pb.	Zn.	Bi.	WO ₃	Ag g/t	
	6.0	52.1	46.1	0.01	0.01	0.02	< 0.1	0.1	< 0.01	0.04	0.003	0.05	1	
	including:-													
	49.0	51.0	2.0	0.19	0.01	0.03	< 0.1	< 0.1	< 0.01	0.05	0.004	0.02	1	
	58.7	62.5	3.8	0.20	< 0.01	0.09	< 0.1	0.5	0.01	0.02	0.004	0.02	1	
	including:-													
	59.8	61.3	1.5	0.40	< 0.01	0.13	< 0.1	0.3	0.02	0.03	0.004	0.02	1	

059027

HOLE No. FED 7

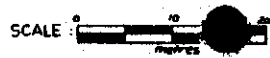

RENISON LIMITED
DIAMOND DRILL HOLE PLOT

027

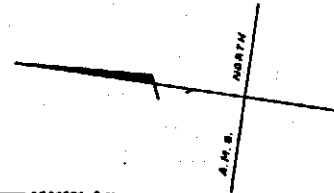
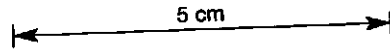

E 350 007 - 0 N
349 007 - 0 E

3550070 - 0 N
349012 - 0 W

PLAN

DIP PROFILE

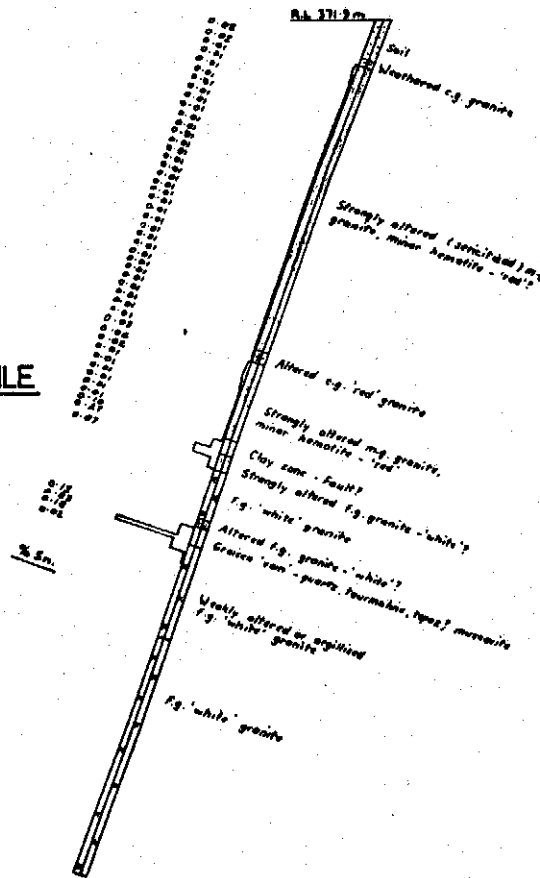

059028

DIAMOND DRILL RECORD

HOLE NUMBER : Fed 7

LOGGED BY : P. Roberts

028

INTERVAL (m)		RECOVERY		DESCRIPTION	FORM.	% Sn.											
FROM	TO	m	%			FROM	TO	TOTAL	ACID SOL.	% Cu.	% As.	% S.	% Pb.	% Zn.	% Bi.	g/t Ag	% WO ₃
0.0	6.0	-	-	0-6.0 soil and clay, also weathered granite 5.0-6.0m													
6.0	8.5	2.5	100	6.0-8.5 Pale grey-green very altered medium to coarse grained granite. Felspars and quartz replaced by clay (talco?) and mica Small (0.5-2.0mm) clear quartz crystals and soft specular Hematite lining vugs.	"red"	6.0	7.0	0.05	0.01	0.01	<0.1	<0.1	<0.01	0.03	0.002	< 1	0.06
						7.0	8.0	0.02	0.01	0.01	<0.1	<0.1	<0.01	0.02	0.002	< 1	0.06
						8.0	9.0	0.01	0.01	0.02	<0.1	<0.1	<0.01	0.03	0.004	< 1	0.06
8.5	11.5	1.8	60	8.5-14.6 As above but with only minor mica numerous vugs. Abundant hematite largely lining vugs but occasionally apparently replacing primary minerals. Argillic alteration 10.1-10.3m, probably also in core loss zone 10.3-115m. Granitic texture more apparent 13.0-14.6m Thin section 1.3m.	"red"	9.0	10.0	0.01	0.01	0.02	<0.1	<0.1	<0.01	0.01	0.006	1	0.06
						10.0	11.0	0.01	0.01	0.01	<0.1	<0.1	<0.01	0.01	0.002	1	0.07
						11.0	12.0	0.01	<0.01	0.02	<0.1	<0.1	<0.01	0.01	0.002	< 1	0.07
						12.0	13.0	<0.01	0.01	0.02	<0.1	<0.1	<0.01	0.01	0.001	1	0.07
						13.0	14.0	<0.01	0.01	0.01	<0.1	<0.1	<0.01	0.02	<0.001	< 1	0.08
14.5	17.1	2.6	100	14.6-20.2 medium to coarse grained altered granite. Felspars pale yellow stained or replaced by chlorite and yellow-green pinite(?) latter are probably ex-plagioclase. Total replacement of feldspars 14.8-15.0m, 19.4-19.6m. Quartz generally unaltered. Trace pyrite. Several thin (5mm) quartz/tourmaline veins. Minor hematite 19.0-13.3m and 19.6-20.2m Thin section 15.1m.	"red"?	14.0	15.0	<0.01	0.01	0.02	<0.1	<0.1	<0.01	0.02	<0.001	1	0.07
17.1	20.2	3.1	100			15.0	16.0	0.01	<0.01	0.01	<0.1	<0.1	<0.01	0.03	<0.001	1	0.07
						16.0	17.0	<0.01	<0.01	0.01	<0.1	<0.1	<0.01	0.02	0.002	1	0.07
						17.0	18.0	<0.01	<0.01	0.01	<0.1	<0.1	<0.01	0.03	0.002	2	0.07
						18.0	19.0	<0.01	<0.01	0.02	<0.1	<0.1	<0.01	0.03	0.001	1	0.06
						19.0	20.0	<0.01	<0.01	0.02	<0.1	<0.1	<0.01	0.03	<0.001	1	0.07
						20.0	21.0	<0.01	<0.01	0.02	<0.1	<0.1	<0.01	0.02	0.002	2	0.08
20.2	23.2	2.6	87	20.2-36.3 Grey-green very strongly altered medium grained granite consisting of a granular aggregate of grey-green clays, chlorite and soft specular hematite. Vuggy in places. Very soft pale yellow clay occas. infilling vugs particularly at 30-30.5m. Locally intensely hematized forming a hematite/chlorite rock. Massive hematite "vein" at 33.8m 3cm thick at 40° to c.a. Less altered, harder 26.1-27.0m - v. pale orange pink feldspar phenocrysts in a fine to medium grained altered grey-green groundmass, hematite forming veins or as grains rimmed by quartz, also at 35.5-36.3m	"red"?	21.0	22.0	<0.01	<0.01	0.01	<0.1	<0.1	<0.01	0.01	0.001	2	0.08
23.2	26.3	2.2	71			22.0	23.0	<0.01	0.01	0.02	<0.1	<0.1	<0.01	0.02	0.001	2	0.07
26.3	27.0	0.7	100			23.0	24.0	<0.01	0.01	0.02	<0.1	<0.1	<0.01	0.04	0.002	1	0.07
27.0	31.0	3.6	90			24.0	25.0	<0.01	<0.01	0.01	<0.1	<0.1	<0.01	0.07	0.002	2	0.08
31.0	32.5	1.5	100			25.0	26.0	<0.01	0.01	0.02	<0.1	<0.1	<0.01	0.05	0.003	2	0.08
32.5	35.5	3.0	100			26.0	27.0	<0.01	0.01	0.03	<0.1	<0.1	<0.01	0.04	0.002	3	0.09
						27.0	28.0	<0.01	0.01	0.02	<0.1	<0.1	<0.01	0.03	0.003	4	0.09
						28.0	29.0	<0.01	0.01	0.02	<0.1	<0.1	<0.01	0.04	0.002	2	0.08
						29.0	30.0	<0.01	0.01	0.02	<0.1	<0.1	<0.01	0.03	0.002	1	0.08
						30.0	31.0	<0.01	0.01	0.01	<0.1	<0.1	<0.01	0.05	0.002	1	0.08
35.5	38.5	3.0	100	36.3-38.35 Pink and brown altered medium grained granite consisting of pink kaolinized (?) feldspars and soft specular hematite pervasively veined and/or impregnated by brown limonite. Partly vuggy, vugs lined with yellow-brown limonite Chlorite locally replacing feldspars	"red"?	31.0	32.0	<0.01	0.01	0.03	<0.1	<0.1	<0.01	0.04	0.002	2	0.03
						32.0	33.0	<0.01	0.01	0.03	<0.1	<0.1	<0.01	0.04	0.010	2	0.04
						33.0	34.0	<0.01	<0.01	0.03	<0.1	<0.1	<0.01	0.03	0.007	2	0.06
						34.0	35.0	<0.01	0.01	0.03	<0.1	<0.1	<0.01	0.02	0.002	1	0.03
						35.0	36.0	<0.01	0.01	0.03	<0.1	<0.1	<0.01	0.03	0.004	1	0.03
						36.0	37.0	<0.01	0.01	0.03	<0.1	<0.1	<0.01	0.03	0.005	1	0.04
						37.0	38.0	<0.01	0.01	0.02	<0.1	<0.1	<0.01	0.02	0.005	2	0.03

059029

029

DIAMOND DRILL RECORD

HOLE NUMBER : Fed 7

LOGGED BY : P. Roberts

MWPS

INTERVAL (m)		RECOVERY		DESCRIPTION	FORM.	% Sn.											
FROM	TO	m	%			FROM	TO	TOTAL	ACID SOL.	% Cu.	% As.	% S.	% Pb.	% Zn.	% Bi.	g/t Ag	% WO ₃
38.5	41.5	3.0	100	38.55-38.8 Pink coarse grained granite consisting largely of pink feldspar(?) with lesser clots and veins of specular hematite and minor secondary quartz, chlorite and white clay. Abundance of pink(K-) feldspar suggests that some is secondary. Thin section 38.6m	"red"	38.0	39.0	<0.01	0.01	0.02	<0.1	<0.1	<0.01	0.02	0.002	2	0.02
				38.8-40.0 Medium to coarse grained altered granite consisting of abundant pink feldspars and lesser specular hematite, pervasively veined and impregnated by yellow-brown limonite. Hematite partly hydrated to goethite in places. Chloritised 38.7-40.0m	"red"	39.0	40.0	<0.01	0.01	0.02	<0.1	<0.1	<0.01	0.03	0.003	2	0.04
				40.0-40.7 Hematite/clay/quartz rock. Probably replacement of medium grained granite, remnant feldspars 40.4-40.6m Consists of aggregate of hematite and quartz veined by and interspersed with pale green talcose clay. Core very broken	"red"?	40.0	41.0	0.03	0.02	0.03	<0.1	<0.1	<0.01	0.04	0.005	1	0.05
41.5	44.5	3.0	100	40.7-43.6 Brown altered granite similar to 38.8-40.0m, Goethite filled joint running parallel to c.a. 40.7-43.1m. Soft green clayey alteration 43.2-43.3m	"red"?	41.0	42.0	0.04	0.02	0.03	0.2	<0.1	<0.01	0.06	0.003	1	0.04
						42.0	43.0	0.02	0.01	0.04	<0.1	<0.1	<0.01	0.06	0.004	1	0.04
44.5	47.5	2.8	93	43.6-47.5 Pink and olive green altered granite consisting of pink feldspar(?) and (usually lesser) chlorite, green and grey clays. At 44.6-44.8m the green clays show a preferred orientation at ~35° to c.a. Minor hematite 43.6-43.7 Green clays predominate 45.4- 45.8m, and contain abundant pyrite. Limonite staining 46.8-47.1m. Vuggy	"red"?	43.0	44.0	<0.01	0.01	0.03	<0.1	<0.1	<0.01	0.05	0.004	1	0.03
						44.0	45.0	<0.01	0.01	0.03	<0.1	0.3	0.01	0.07	0.002	1	0.02
						45.0	46.0	<0.01	0.01	0.03	<0.1	2.5	0.01	0.07	0.004	<1	0.03
						46.0	47.0	<0.01	0.01	0.02	<0.1	0.8	0.01	0.07	0.005	2	0.02
						47.0	48.0	<0.01	0.01	0.03	<0.1	<0.1	<0.01	0.05	0.002	1	0.03
				Abundance of pink feldspar(?) suggests that some is secondary.													
47.5	49.8	1.2	52	47.5-48.5 Grey-green very altered medium grained granite comprising chlorite, specular hematite and 47.5-47.9 pink feldspar. Vuggy, vugs becoming finer towards lower contact.	"red"?	48.0	49.0	<0.01	0.01	0.03	<0.1	<0.1	0.01	0.05	0.003	<1	0.03
49.8	52.0	2.2	100	48.5-50.3 Pale grey-green and pale olive green talcose and (?) chloritic clay. Core very broken, 1.1m core loss at 48.5-49.8m. Fault gouge? Thin section 50.1m	Fault "red" (?)	49.0	50.0	0.10	0.01	0.03	<0.1	0.4	<0.01	0.06	0.003	1	0.03
				50.3-52.1 Pale grey-green and brown extremely altered fine grained granite(?) consisting of partly talcose clays, chlorite and secondary quartz. Brown limonitic staining in parts. Occasional minor sericite. Thin section 51.0m	"white"	50.0	51.0	0.27	0.01	0.03	<0.1	<0.1	0.01	0.05	0.004	1	0.02
						51.0	52.0	0.07	0.01	0.02	<0.1	<0.1	<0.01	0.03	0.004	2	0.02
52.0	53.5	1.5	100	52.1-57.6 Fine grained white and pale yellow fine grained granite .	"white"	52.0	53.0	<0.1									
53.5	56.5	3.0	100	Average grain size 0.5mm. Feldspars partly yellow, kaolinized and at		53.0	54.0	<0.1									
56.5	59.5	3.0	100	52.1-52.5 plagioclase feldspars replaced by pyrite Abundant grains and clots of black tourmaline up to 1cm, diam,	"white"	54.0	55.0	<0.1									
						55.0	56.0	<0.1									

059030

030

DIAMOND DRILL RECORD

HOLE NUMBER : Fed 7

LOGGED BY : P. Roberts.

INTERVAL (m)		RECOVERY		DESCRIPTION	FORM.	% Sn.											
FROM	TO	m	%			FROM	TO	TOTAL	ACID SOL.	% Cu.	% As.	% S.	% Pb.	% Zn.	% Bi.	g/t Ag	% WO ₂
				Few thin (1cm) quartz-tourmaline veins cut granite at varied \angle 's to c.a. and are enclosed by a slightly coarser grained "shell"		56.0	57.0	<0.1									
						57.0	58.0	<0.1									
				57.6-58.7 Grey-green altered fine grained granite-feldspars partly replaced by chlorite/pinite	"white"	58.0	59.7	<0.1									
59.5	62.5	3.0	100	58.7-60.5 "Vein" of quartz tourmaline and topaz. Abundant pyrite. Includes greisen vein of tourmaline/muscovite approximately parallel to c.a. at 59.9-60.1m, enclosed in an irregular siliceous envelope from 59.8-60.3m.	"white"	59.7	59.8	0.13	0.01	0.09	<0.1	1.3	0.01	0.01	0.004	2	0.01
						59.8	60.3	0.83	<0.01	0.04	<0.1	<0.1	0.01	0.01	0.003	2	0.03
						60.3	61.3	0.18	<0.01	0.17	<0.1	0.5	0.03	0.03	0.004	1	0.02
62.5	64.6	2.1	100	60.5-70.9 Fine grained, white granite; feldspars partly kaolinized and yellow, or altered to green clay. Abundant quartz/tourmaline veins occasionally with coarse cores and fine grained margins. Some very irregular micropegmatite development usually containing abundant tourmaline needles. Few coarse quartz-tourmaline clots.	"white"	61.3	62.5	0.02	<0.01	0.03	<0.1	<0.1	0.01	0.01	0.003	<1	0.01
64.6	67.7	2.9	94														
67.7	70.8	3.1	100														
70.8	73.8	3.0	100	70.9-81.2 Fine grained white granite comprising quartz feldspar and needles of tourmaline. Numerous yellow clay-coated joints cutting core. Occasional "veins" and clots of quartz/tourmaline	"white"												
73.8	74.5	0.7	100														
74.5	77.5	3.0	100														
77.5	79.8	2.3	100	Feldspars partly kaolinized and pale yellow.													
79.8	82.9	3.1	100	81.7-98.2 Fine grained white granite as above but with only rare yellow clay-coated fragments. Occasionally medium to coarse grained micropegmatite developments. Probably partly greisenized to a quartz/feldspar/topaz/tourmaline rock partic. 94.5-98.2m	"white"												
82.9	86.0	3.1	100														
86.0	89.0	3.0	100														
89.0	92.1	3.1	100														
92.1	95.2	3.1	100														
95.2	98.2	3.0	100	Thin section 92.4m													
				End of Hole 98.2m.													

059031