

20 - 109

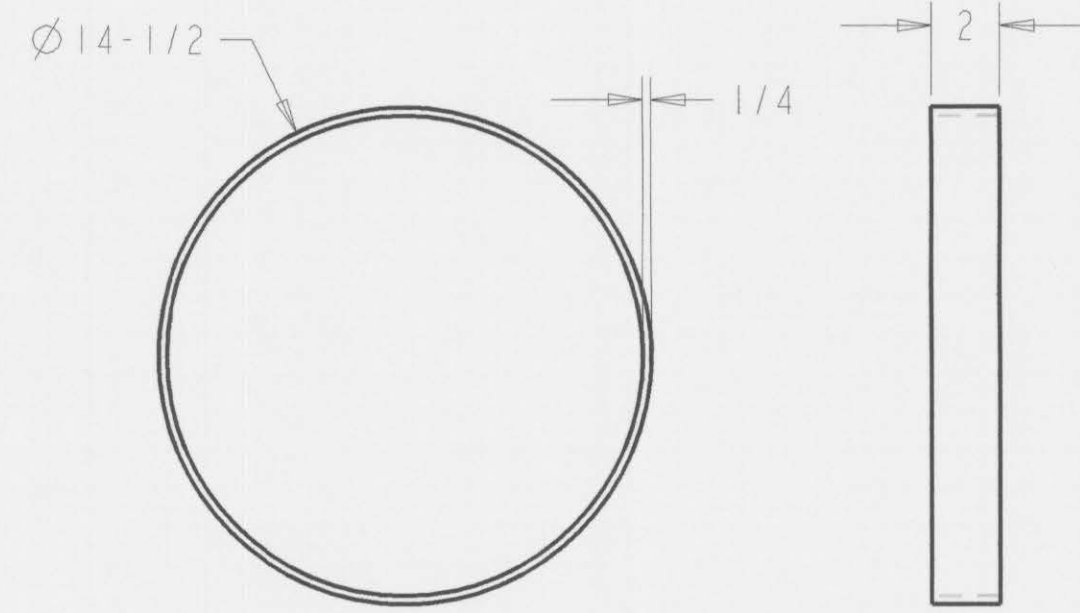

26 - 112

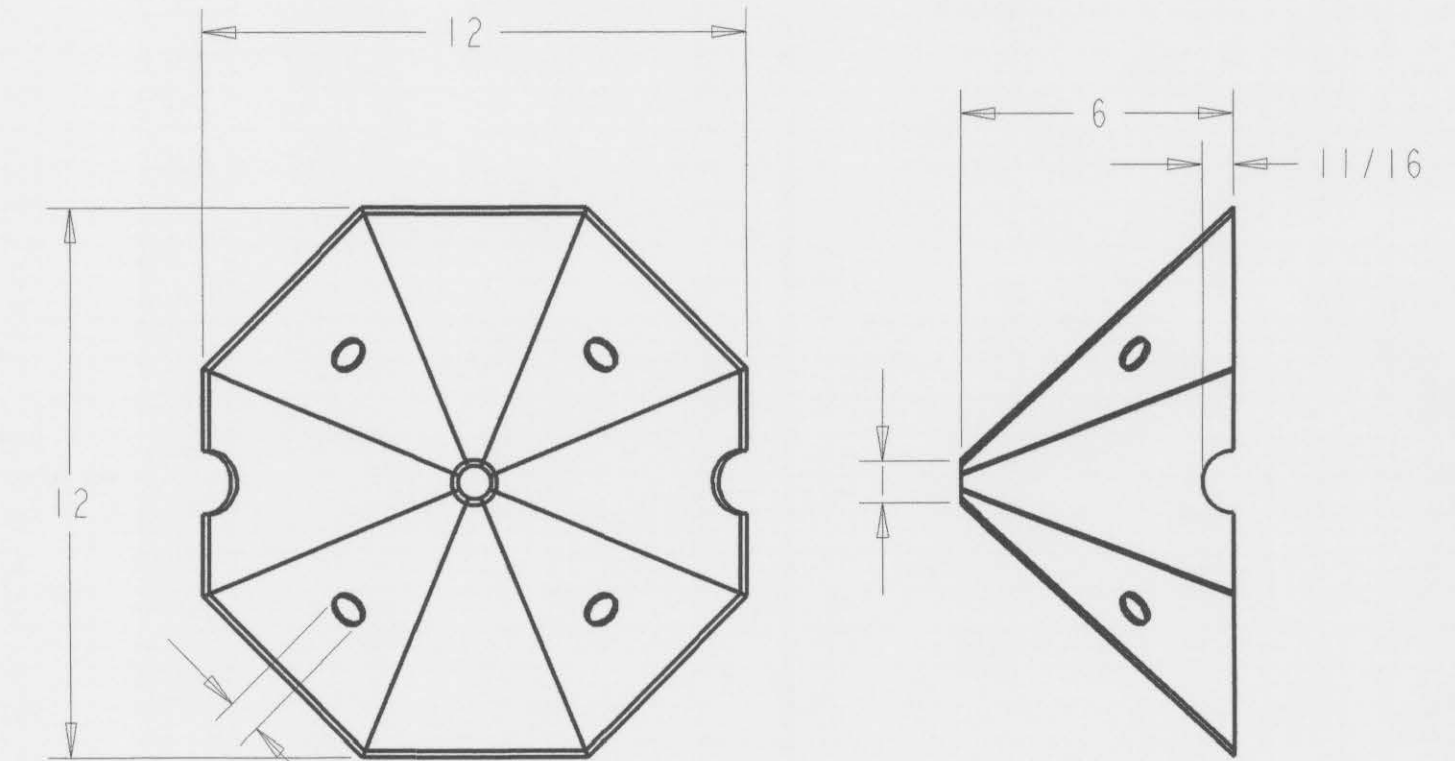

32 - 113

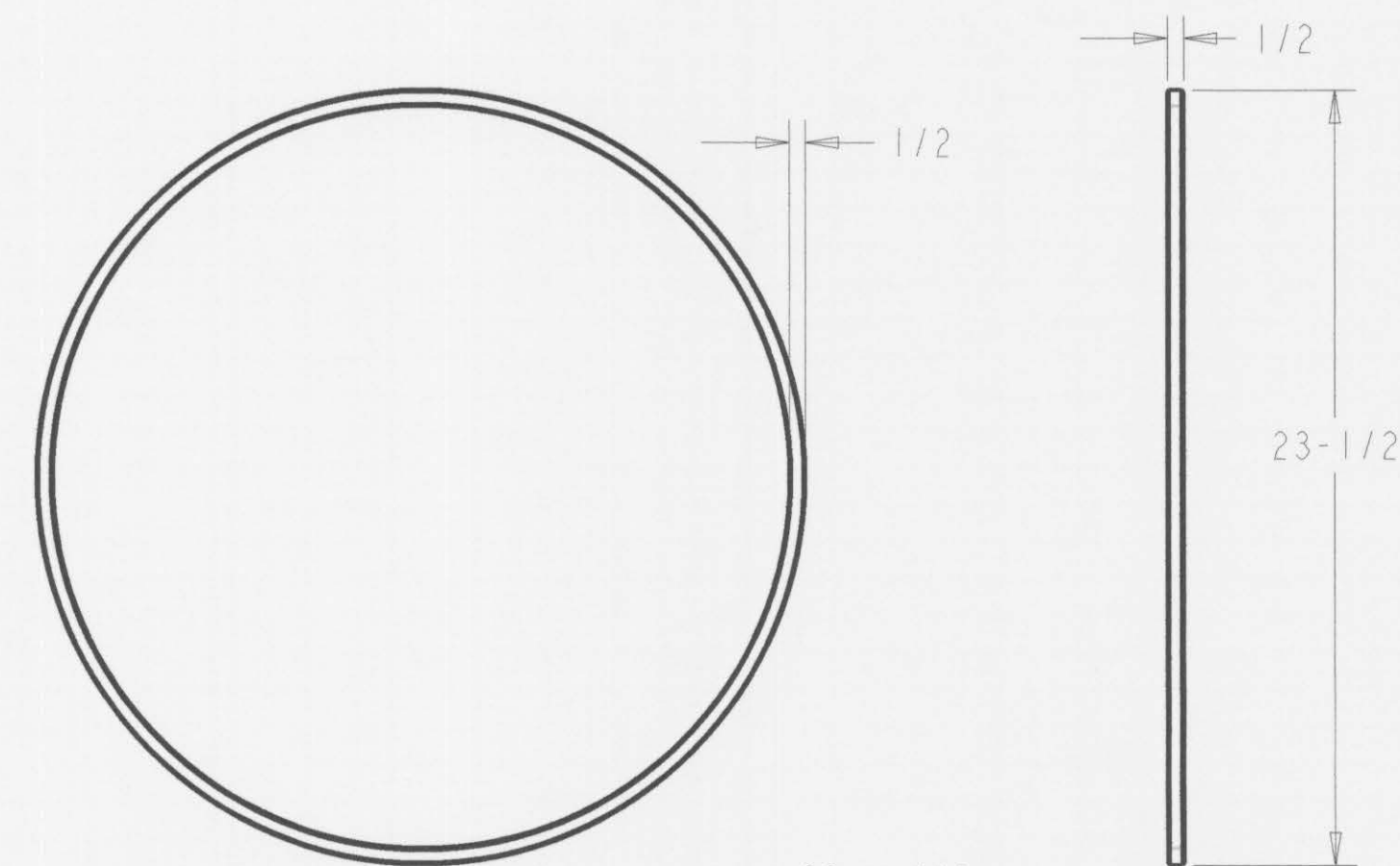

23 - 110

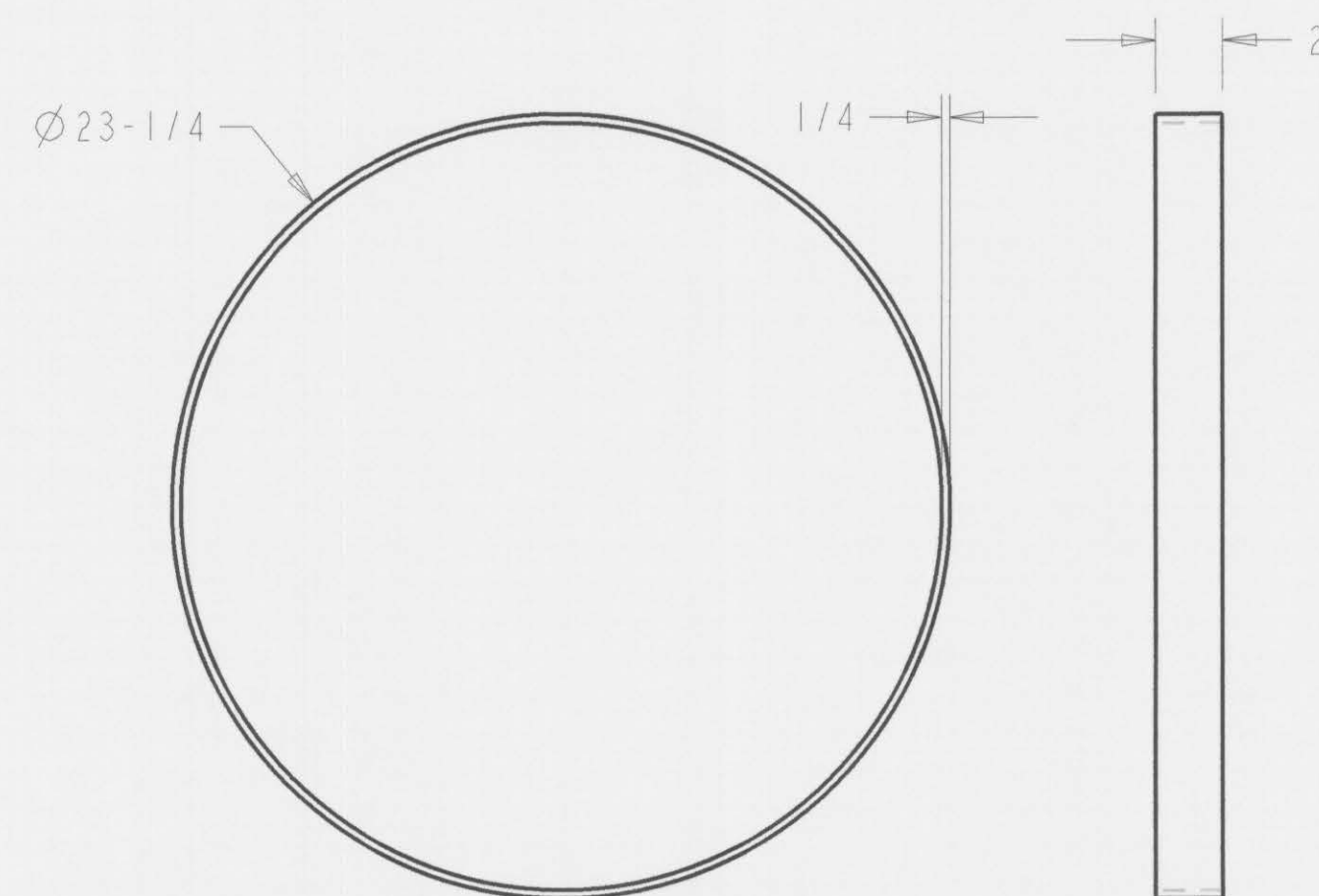

29 - 131

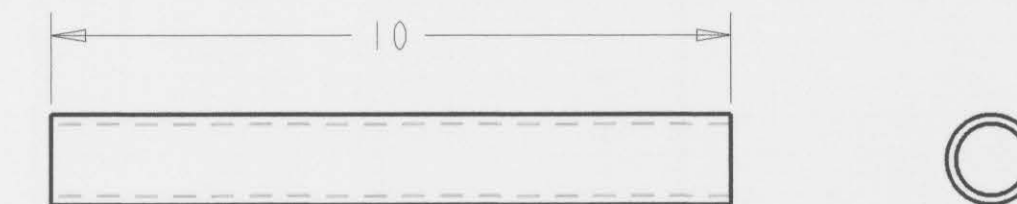

33 - 114

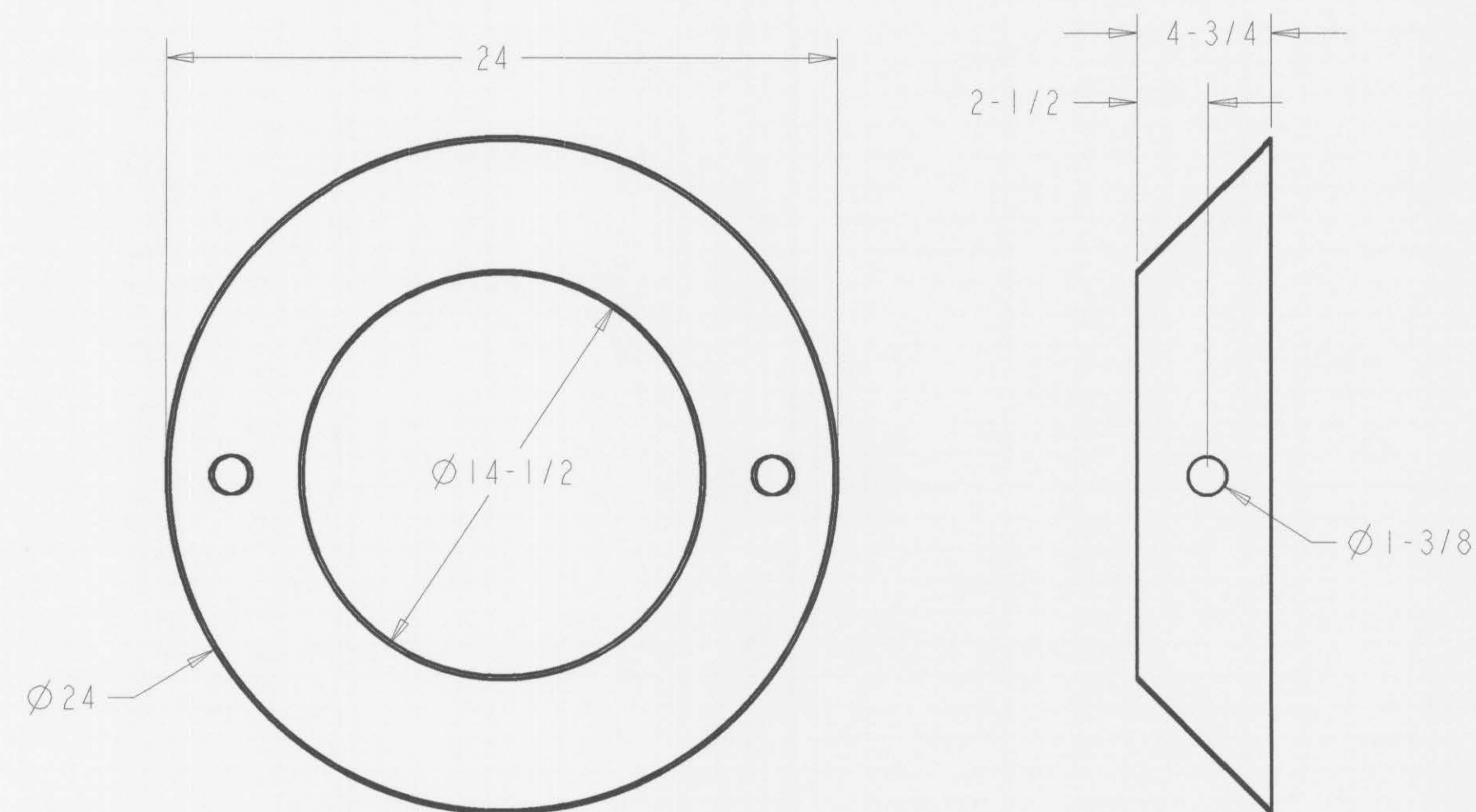

25 - 111

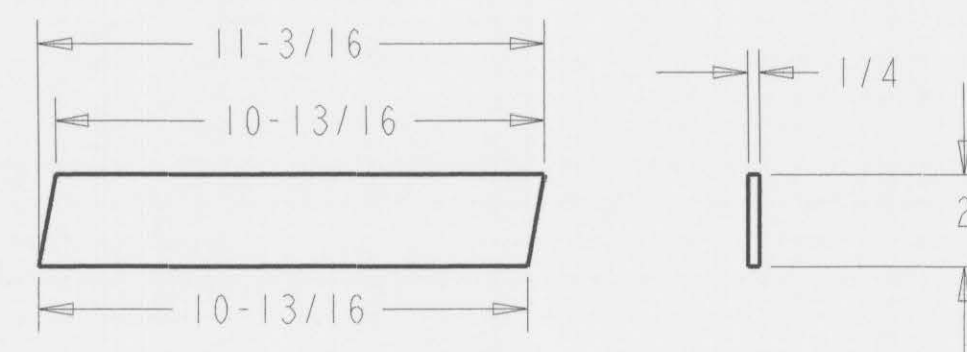

30 - 132



31 - 133

33	2	1-1/2" SCH 40 PIPE X 10"	5
32	1		5
31	2	1" SCH 40 PIPE X 2"	5
30	12	1/4" F BAR X 2" X 11-3/16"	5
29	2	1/4" F BAR X 2" X 73-1/16" FLAT	5
26	1	1/4" F BAR X 2" X 45-9/16" FLAT	5
25	1		5
23	1	1/2" SO TUBING X .095 WALL X 73-13/16" FLAT	5
20	1	10 GA X 11-1/2" X 75-3/8" FLAT	5
ITEM	QTY	DESCRIPTION - MATERIAL	REF DRAWING

THIS DRAWING IS PROTECTED BY U.S. COPYRIGHT LAW. ANY REPRODUCTION WITHOUT WRITTEN CONSENT OF GOLDFIELD INTERNATIONAL IS PROHIBITED.		GOLDFIELD INTERNATIONAL	
APPROVALS		DATE	TITLE
DESIGN: J. POTTER		06/20/07	JIG PARTS LIST
ENGINEER:		SYSTEM:	24" ROUND JIG
RELEASE TO PROD:		REV:	
REV REL:		FILE NAME:	24RJ-100-FINAL
OTHER:		DESIGNER:	PAW DIEMAN
		SCALE:	
		PAGE:	5
		OF:	10
		DATE:	2007
		STATE:	D
		SUPPLEMENTED:	